

Ball Valves

DN 50...150 PN 80, 100

Designed for operation as shut-off devices in pipelines transporting non-aggressive natural gas and other non-aggressive media at the temperature ranged -60°C to $+80^{\circ}\text{C}$.

Tightness class A per GOST 9544.

Seat seals are made of elastomeric and composite materials. Welded end connection (flanged is possible).

Climatic version is for areas with temperate and cold climate (-60°C thru $+45^{\circ}\text{C}$).

Ball valves are available with a variety of operator options: manual, pneumatic and pneumatic-and-hydraulic.

Over-ground and underground installation.

Manually operated ball valves can be installed in any position, and pneumatically and pneumatically and hydraulically operated ball valves are installed in horizontal pipelines with actuator facing upward.

The average service life before overhaul is no more than 40 years.

The Company reserves the right to make design changes to improve it, while minor changes may not be shown in the Catalog.

Design Features:

- Valve is a stamped two-piece, split body; the design enables to reduce gas escaping into the environment.
- Closure member is sealed with a high wear/erosion resistant elastomeric material.
- Both seats are tightened to the ball ensuring a high leakproof closure member.
- "Trunnion mounted ball" with self-lubricating bearings made of metal-fluoroplastic that makes easy valves control.
- Pneumatically actuated ball valves are furnished with manual overrides.
- Ball valves with pneumatic-and-hydraulic actuator are furnished with hand pump.
- Liquid damper is used in pneumatic actuator.
- Ball valves control units have integral terminal boxes, limit switches, and they do not require additional piping.
- Control voltage is 24V, 110V and 220V.
- Ball valves can be furnished with electric actuators.
- Ball valves for underground installation have corrosion-resistant polymer coating.

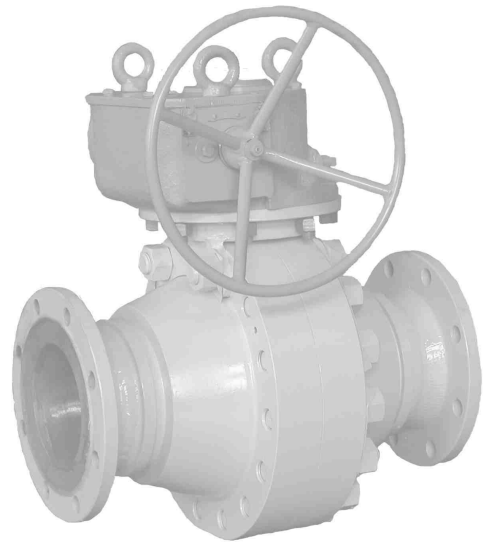

DN 150 PN 100



DN 150 PN 100



DN 50 PN 100



5 Ball Valve DN 50 PN 100 with Manual Actuator

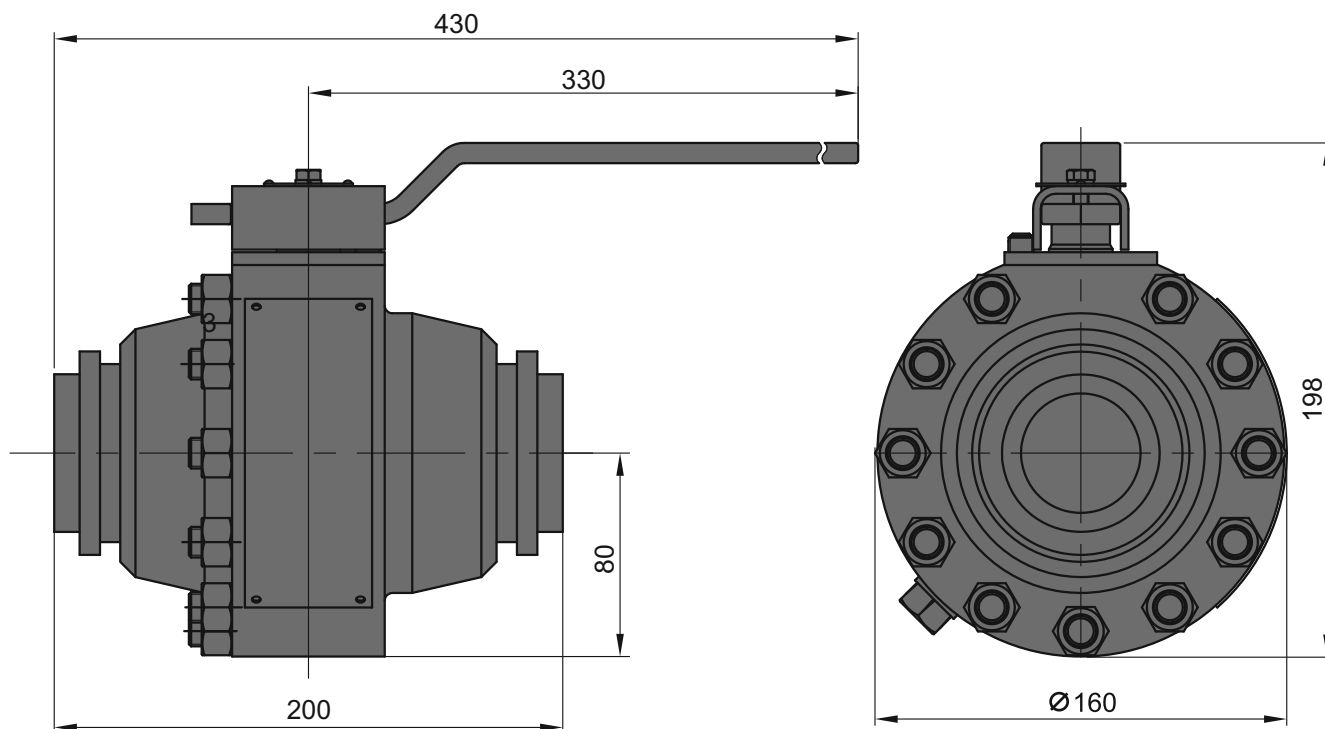

Product designation

Figure designation

Diameter Nominal, DN, mm
 Pressure Nominal, PN, MPa
 Actuator type
 Connection

KSh-50-100-R-NU-UKhL1-Pr

A.1.2750.202.301.00

50
 10.0
 manual
 welded end (WE)*

Material of main parts

Body	steel 10Г2, zinc chromating 15 μ
Ball	steel 10Г2, HCP 25 μ
Stem	steel 38 XA, HCP 21 μ
Seat (cover)	steel 10Г2, zinc chromating 9 μ

* Pipe is beveled to the pipe specified by a Customer.

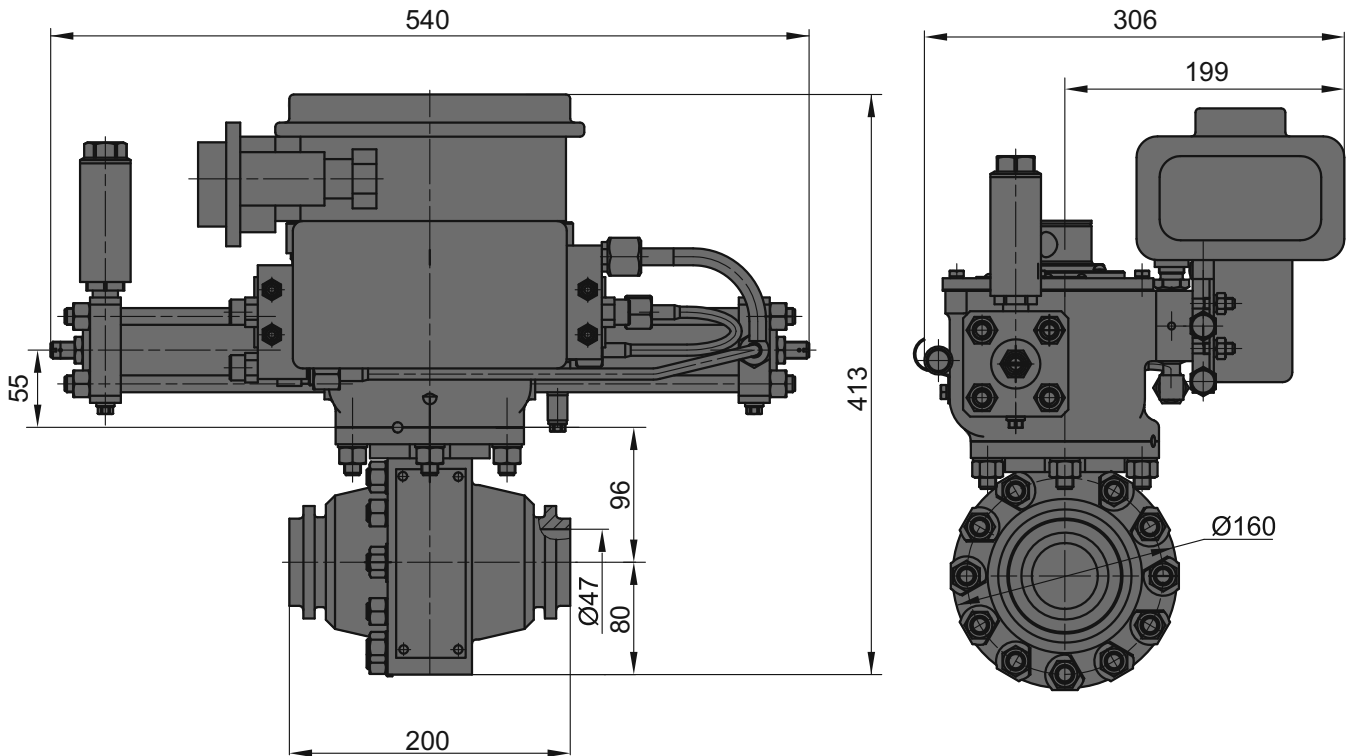

**Product designation****KSh-50-100-PP-NU-UKhL1-Pr****Figure designation****A.1.2750.202.302.00**

Diameter Nominal, DN, mm

50

Pressure Nominal, PN, MPa

10.0

Actuator type

pneumatic

Manual override type

handle

Control unit

electro-pneumatic with built-in limit switches

Actuator operating medium

dry clean non-aggressive gaseous, meet requirements of the unit, separate source supply

Pressure range of operating medium at max. pressure differential, MPa

2.5...10.0

Control unit voltage

24, 110, 220 V/DC

Connection

welded end (WE)*

Material of main parts

Body

steel 10Г2, zinc chromating 15 μ

Ball

steel 10Г2, HCP 25 μ

Stem

steel 38 XA, HCP 21 μ

Seat

steel 10Г2, zinc chromating 9 μ

* Pipe is beveled to the pipe specified by a Customer.



Ball Valve DN 50 PN 100 with Pneumatic Actuator for Underground Installation

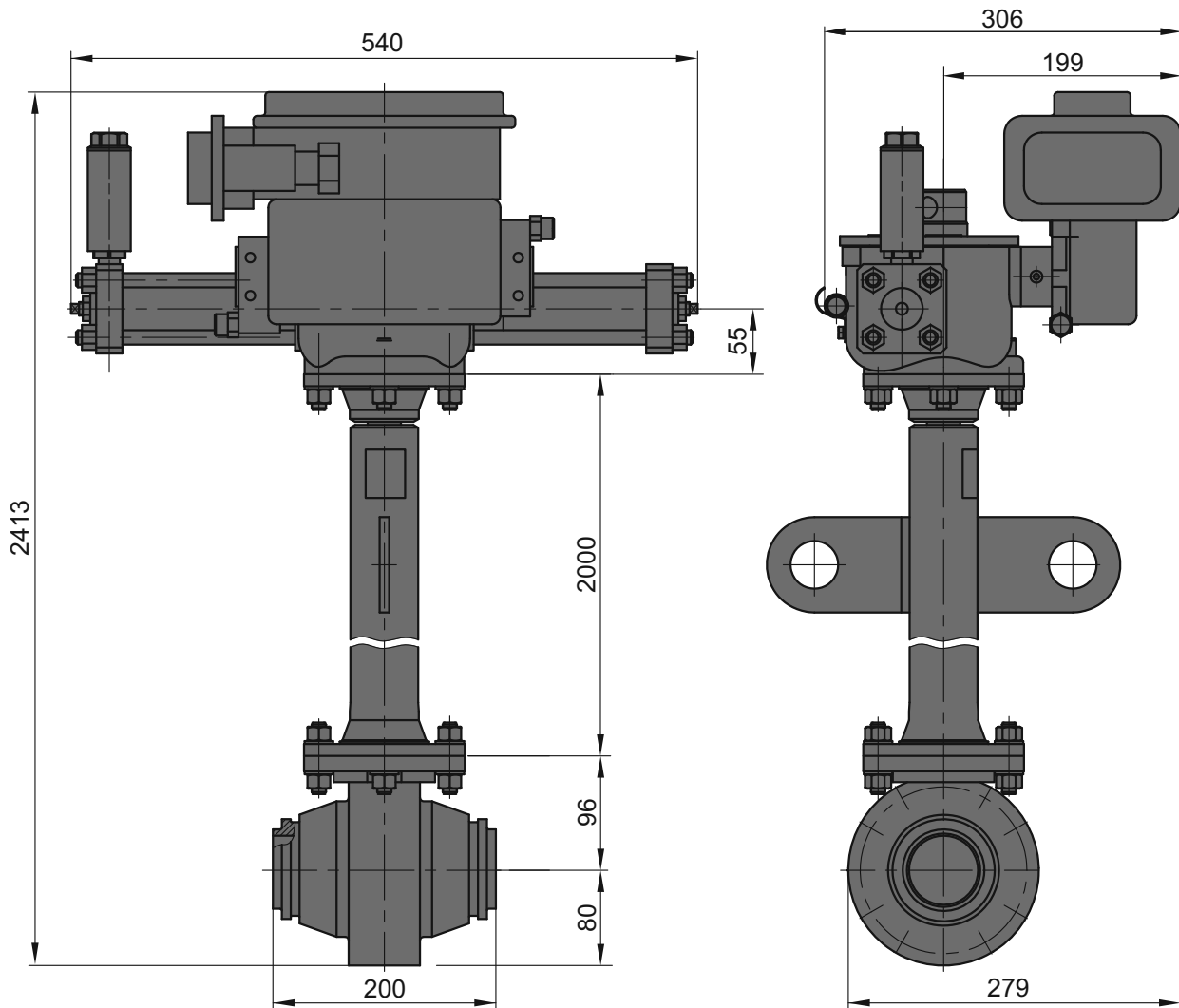

Product designation

Figure designation

Diameter Nominal, DN, mm
Pressure Nominal, PN, MPa
Actuator type
Control unit
Actuator operating medium

Pressure range of operating medium
at max. pressure differential, MPa
Control unit voltage
Connection

KSh-50-100-PP-PU-UKhL1-Pr

1.2750.202.360.00

50
10.0
pneumatic
electro-pneumatic with internal end switches
dry clean non-aggressive gaseous, meet
requirements of the unit, separate source
supply

2.5...10.0
24, 110, 220 V/DC
welded end (WE)*

Material of main parts

Body	steel 10Г2, zinc chromating 15 μ
Ball	steel 10Г2, HCP 25 μ
Stem	steel 38 XA, HCP 21 μ
Seat	steel 10Г2, zinc chromating 9 μ

* Pipe is beveled to the pipe specified by a Customer.

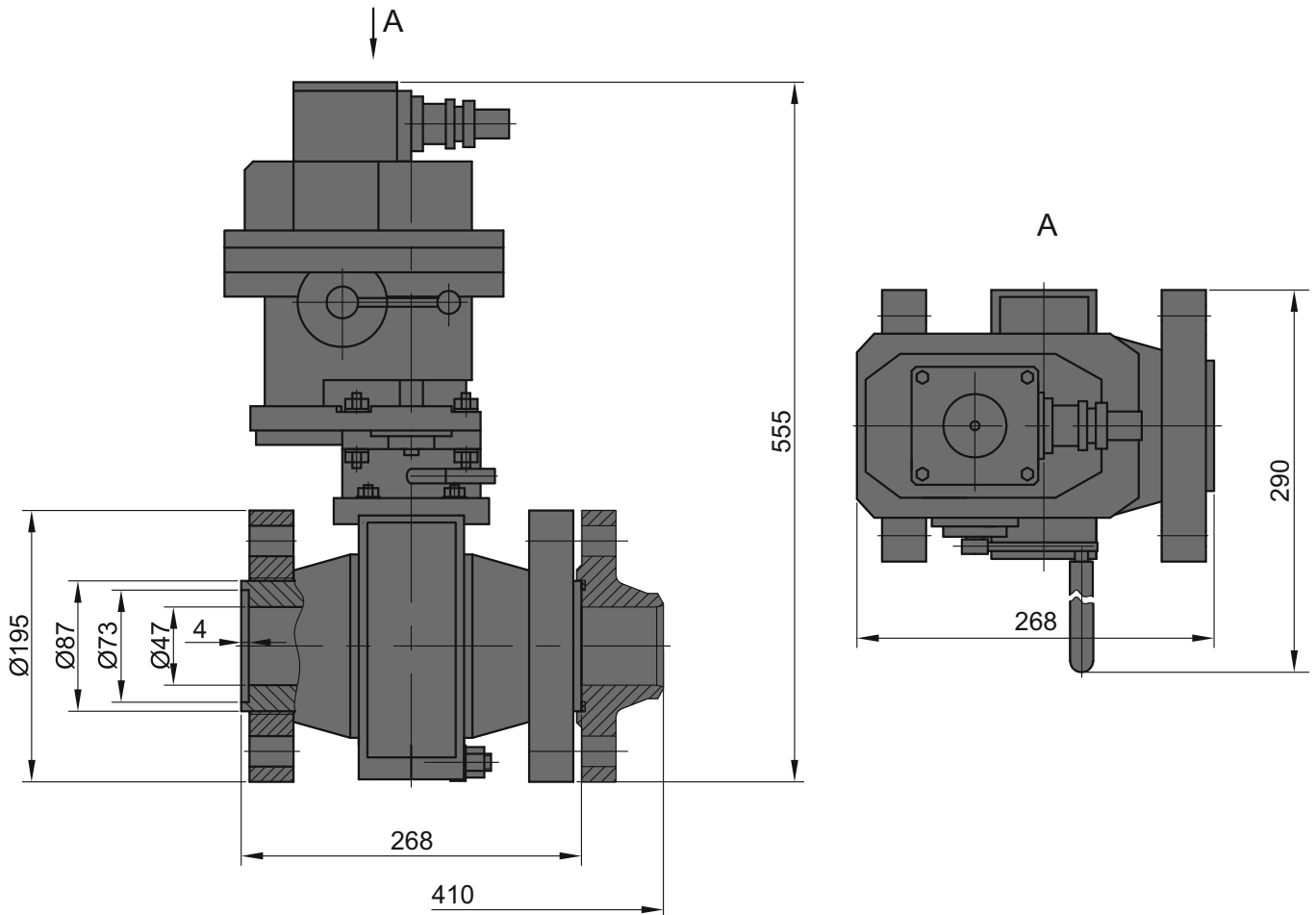

**Product designation****KSh-50-100-EP-NU-UKhL1-F-F****Figure designation****1.2750.230.306.00-07**

Diameter Nominal, DN, mm

50

Pressure Nominal, PN, MPa

10.0

Actuator type

electric

Power Voltage

380 V AC

Connection

Flanged end, with counter flanges, fasteners and sealing parts (WE)*

Material of main parts

Body	steel 08X18H10T
Ball	steel 20X13
Stem	steel 20X13
Seat	steel 10Г2
Flange	steel 10Г2

* Pipe is beveled to the pipe specified by a Customer

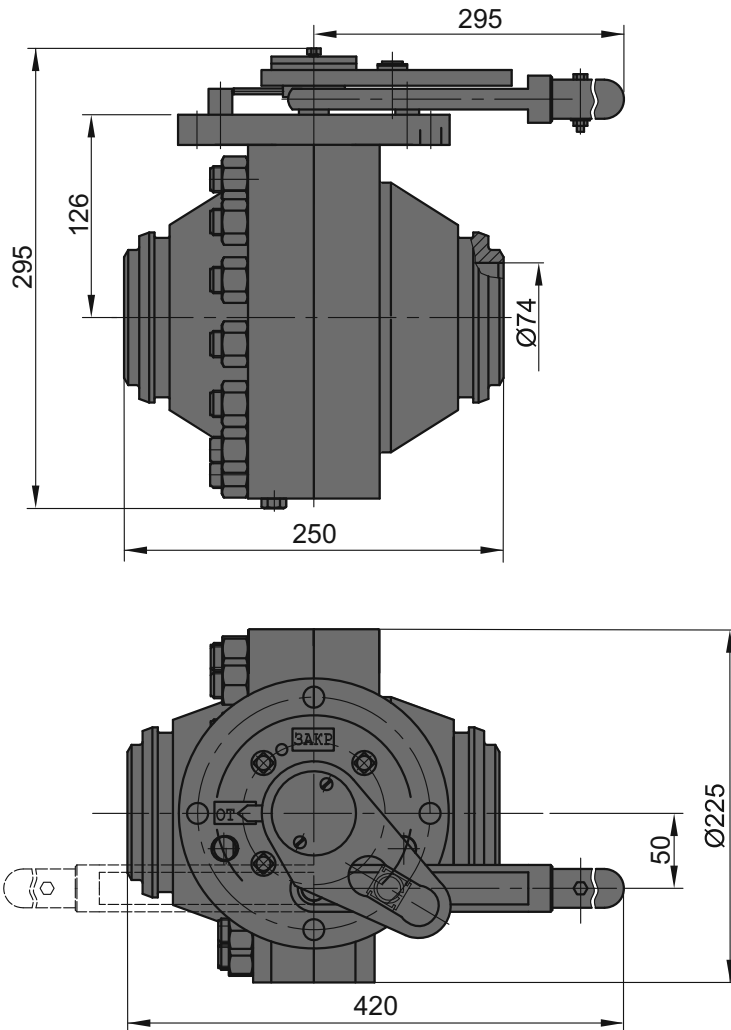

**Product designation****KSh-80-100-R-NU-UKhL1-Pr****Figure designation****1.2750.201.301.00**

Diameter Nominal, DN, mm

80

Pressure Nominal, PN, MPa

10.0

Actuator type

manual

Connection

welded end (WE)*

Material of main parts

Body

steel 09Г2С

Ball

steel 10Г2, HCP 21 μ

Stem

steel 40X, HCP 21 μ

Seat

steel 10Г2, zinc chromating 9 μ

* Pipe is beveled to the pipe specified by a Customer.

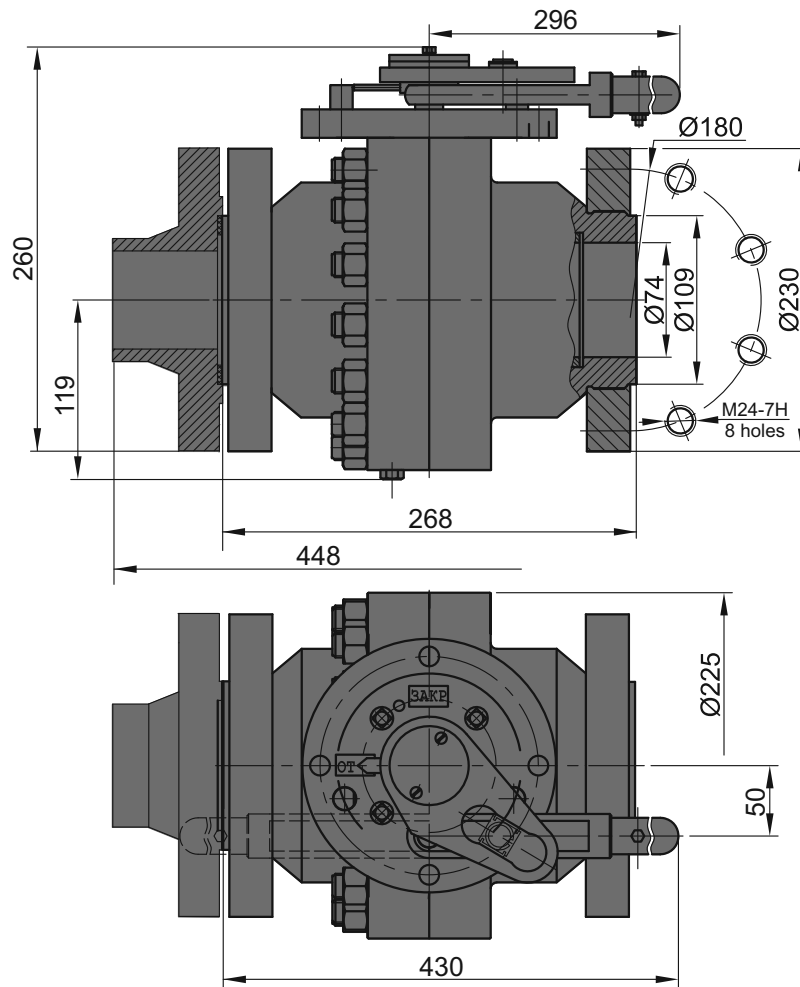

**Product designation**

KSh-80-100-R-NU-UKhL1-F-F

Figure designation

1.2750.237.301.00-01

Diameter Nominal, DN, mm

80

Pressure Nominal, PN, MPa

10.0

Actuator type

manual

Connection

Flanged end, with counter flanges, fasteners and sealing parts (WE)*

Material of main parts

Body

steel 10Г2, zinc chromating 24 μ

Ball

steel 10Г2, HCP 21 μ

Stem

steel 40X, HCP 21 μ

Counter flange

steel 10Г2

Seat

steel 10Г2, zinc chromating 9 μ

* Pipe is beveled to the pipe specified by a Customer.



11 Ball Valve DN 80 PN 100 with Pneumatic Actuator

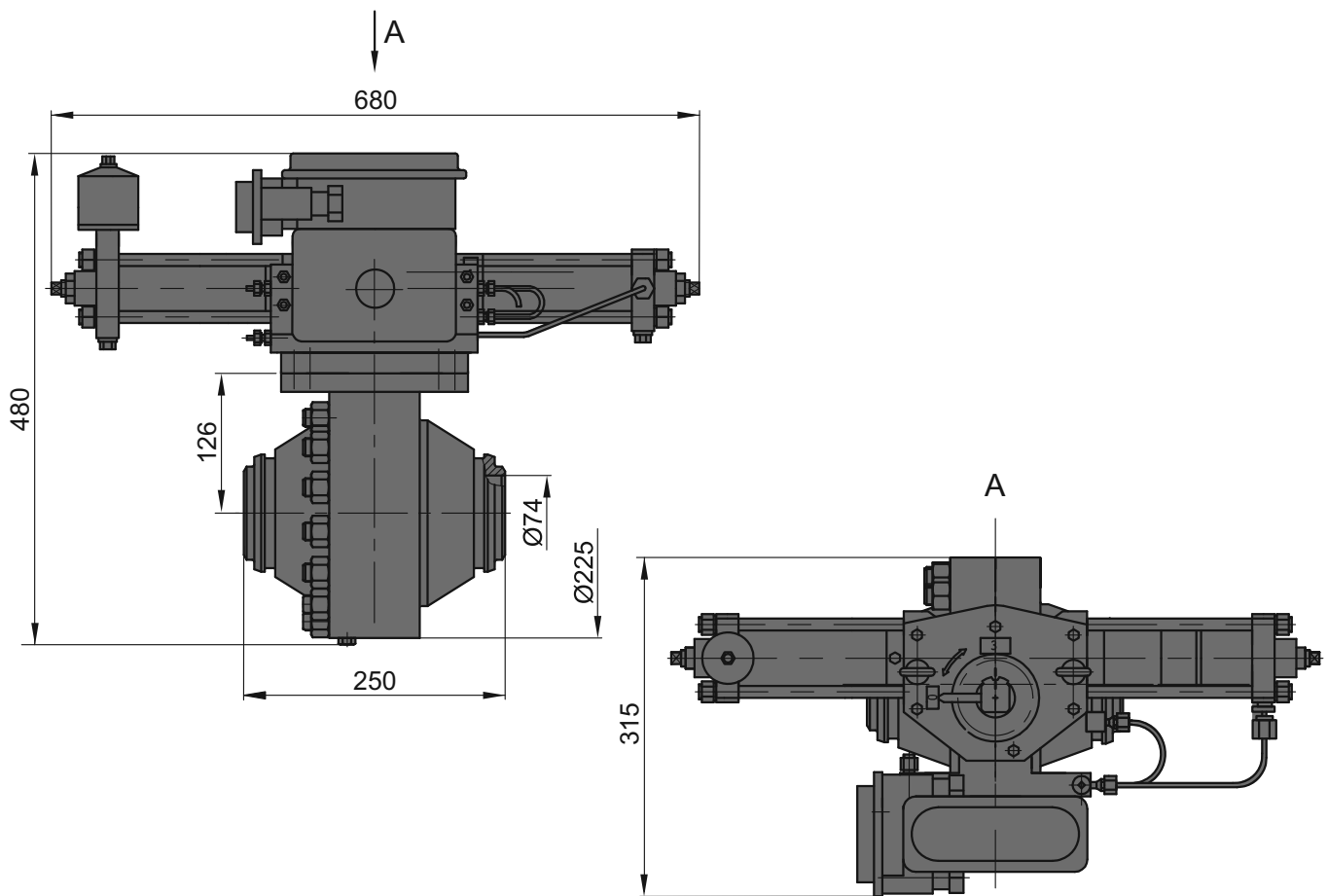

Product designation

Figure designation

Diameter Nominal, DN, mm
 Pressure Nominal, PN, MPa
 Actuator type
 Control unit
 Actuator operating medium

Pressure range of operating medium
 at max. pressure differential, MPa
 Control unit voltage
 Connection

KSh-80-100-PP-NU-UKhL1-Pr

1.2750.201.304.00-01

80
 10.0
 pneumatic
 electro-pneumatic with built-in limit switches
 non-aggressive gaseous,
 separate source supply

2.5...10.0
 24, 110, 220 V/DC
 welded end*

Material of main parts

Body	steel 09Г2С
Ball	steel 10Г2, HCP 21 μ
Stem	steel 40X, HCP 21 μ
Seat	steel 10Г2, zinc chromating 9 μ

* Pipe is beveled to the pipe specified by a Customer.



Ball Valve DN 80 PN 100 with Pneumatic Actuator for Underground Installation

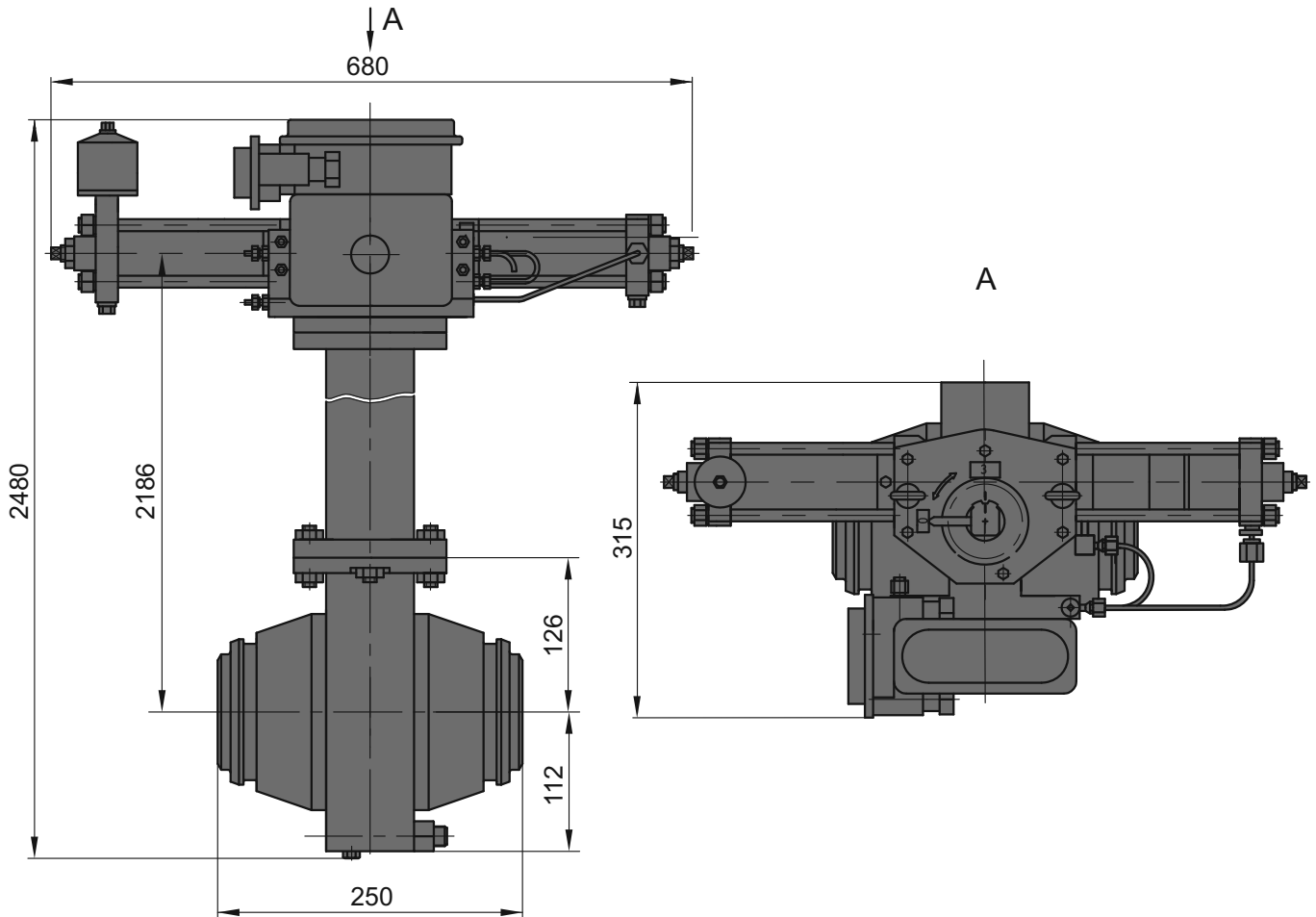

Product designation

Figure designation

Diameter Nominal, DN, mm
Pressure Nominal, PN, MPa
Actuator type
Control unit
Actuator operating medium

Pressure range of operating medium
at max. pressure differential, MPa
Control unit voltage
Connection

KSh-80-100-PP-PU-UKhL1-Pr

1.2750.201.360.00-01

80
10.0
pneumatic
electro-pneumatic with built-in limit switches
non-aggressive gaseous,
separate source supply

2.5...10.0
24, 110, 220 V/DC
welded end (WE)*

Material of main parts

Body	steel 09Г2С
Ball	steel 10Г2, HCP 21 μ
Stem	steel 40X, HCP 21 μ
Seat	steel 10Г2, zinc chromating 9 μ

* Pipe is beveled to the pipe specified by a Customer.



13 Ball Valve DN 80 PN 100 with Electric Actuator

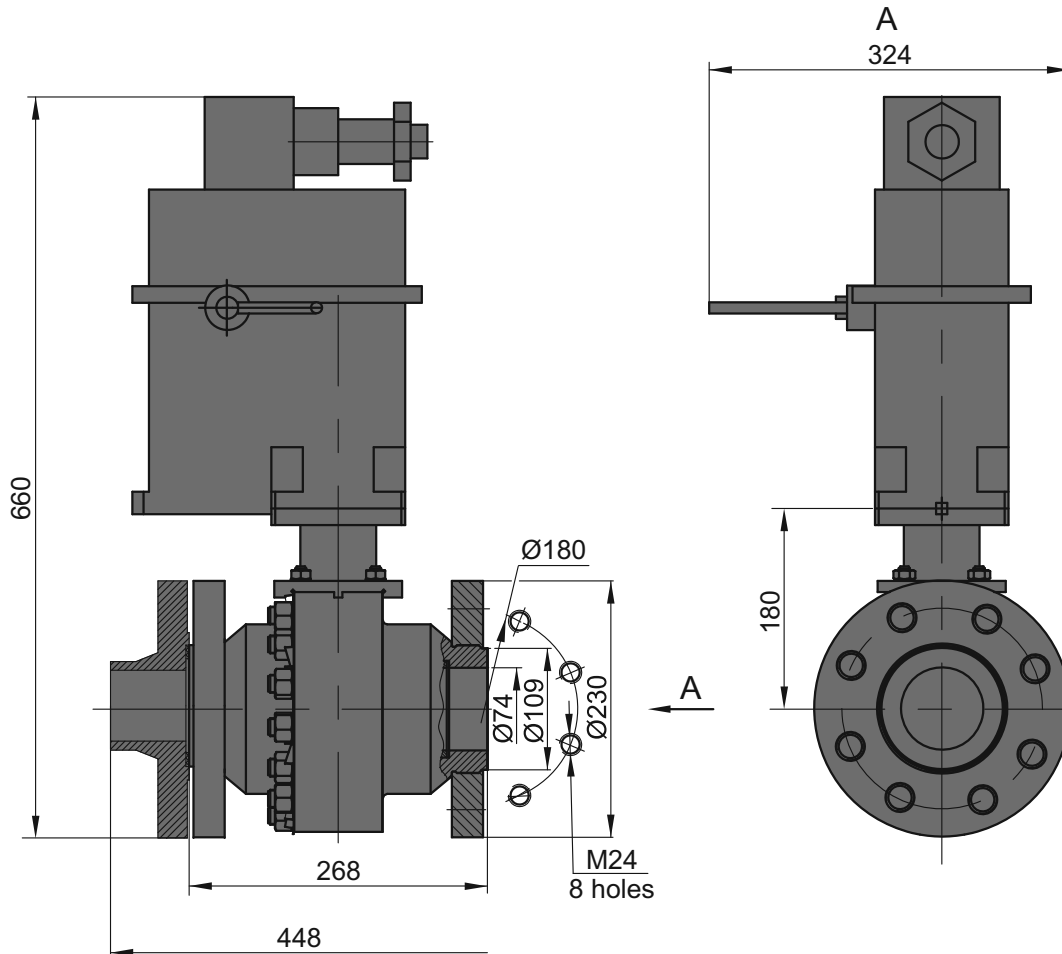

Product designation

KSh-80-100-EP-NU-UKhL1-F-F

Figure designation

1.2750.236.306.00-01

Diameter Nominal, DN, mm

80

Pressure Nominal, PN, MPa

10.0

Actuator type

electric

Voltage

380 V, 3 ph, 50 Hz

Connection

Flanged end, with counter flanges, fasteners and sealing parts (WE)*

Material of main parts

Body	steel 10Г2, zinc chromating 24 μ
Ball	steel 10Г2, HCP 21 μ
Stem	steel 38XA, HCP 21 μ
Flange	steel 10Г2
Seat	steel 10Г2, zinc chromating 9 μ

* Pipe is beveled to the pipe specified by a Customer.

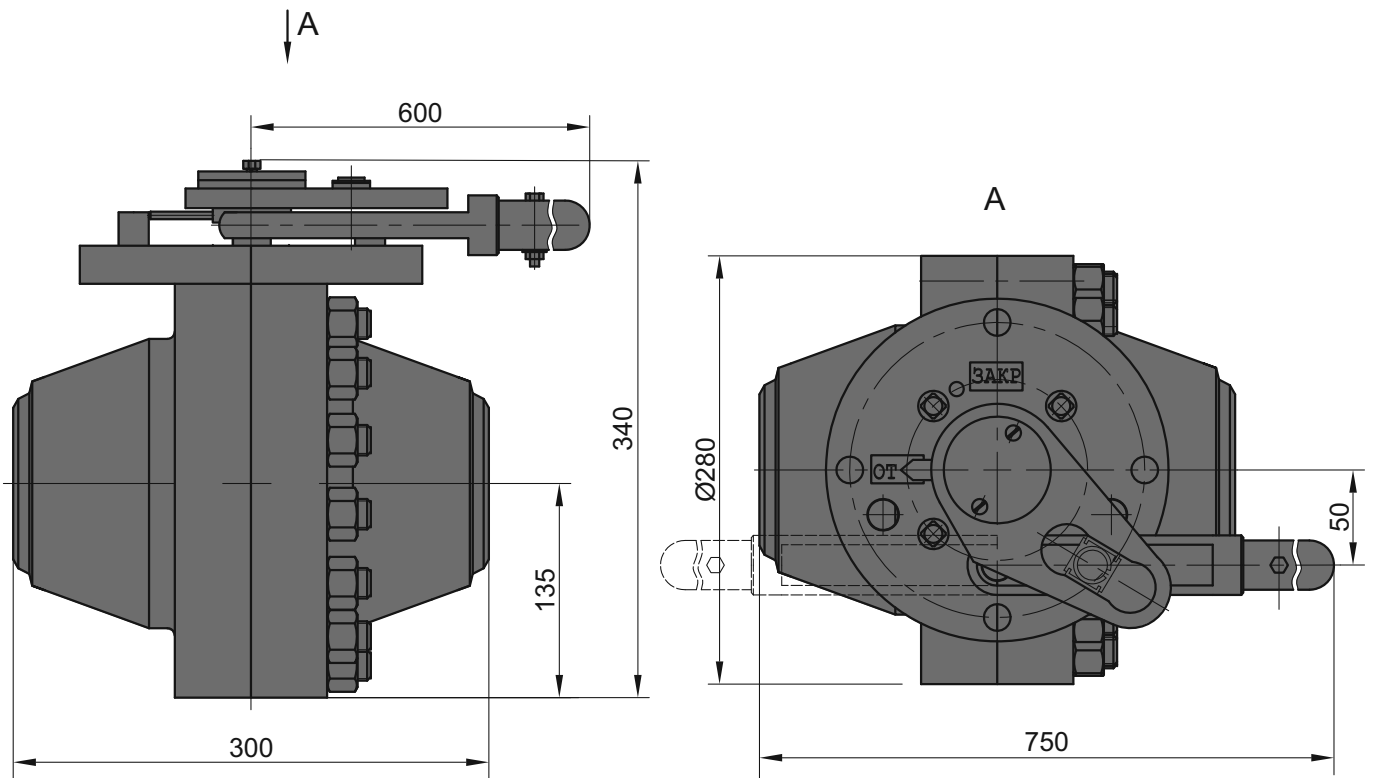

**Product designation****KSh-100-100-R-NU-UKhL1-Pr****Figure designation****1.2750.151.160.00**

Diameter Nominal, DN, mm

100

Pressure Nominal, PN, MPa

10.0

Actuator type

manual

Connection

welded end (WE)*

Material of main parts

Body

steel 09Г2С

Ball

steel 10Г2, HCP 21 μ

Stem

steel 40X, HCP 21 μ

Seat

steel 10Г2, zinc chromating 9 μ

* Pipe is beveled to the pipe specified by a Customer.

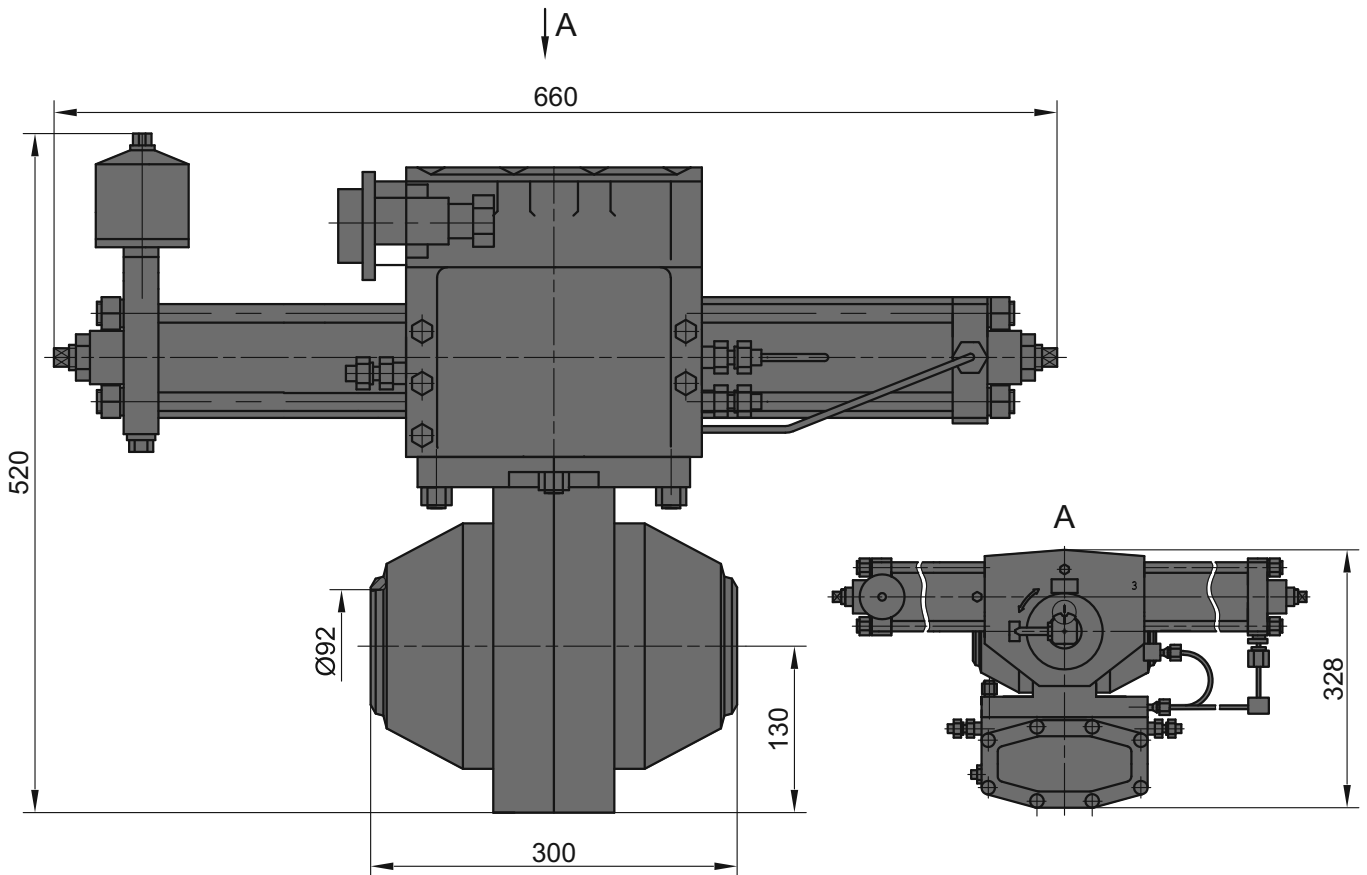

**Product designation****KSh-80-100-PP-NU-UKhL1-Pr****Figure designation****1.2750.151.102.00-06**

Diameter Nominal, DN, mm

100

Pressure Nominal, PN, MPa

10.0

Actuator type

pneumatic

Control unit

electro-pneumatic with built-in limit switches

Actuator operating medium

non-aggressive gaseous,
separate source supplyPressure range of operating medium
at max. pressure differential, MPa

2.5...10.0

Control unit voltage

24, 110, 220 V/DC

Connection

welded end*

Material of main parts

Body

steel 09Г2С

Ball

steel 10Г2, HCP 21 μ

Stem

steel 40X, HCP 21 μ

Seat

steel 10Г2, zinc chromating 9 μ

* Pipe is beveled to the pipe specified by a Customer.



Ball Valve DN 100 PN 100 with Pneumatic Actuator for Underground Installation

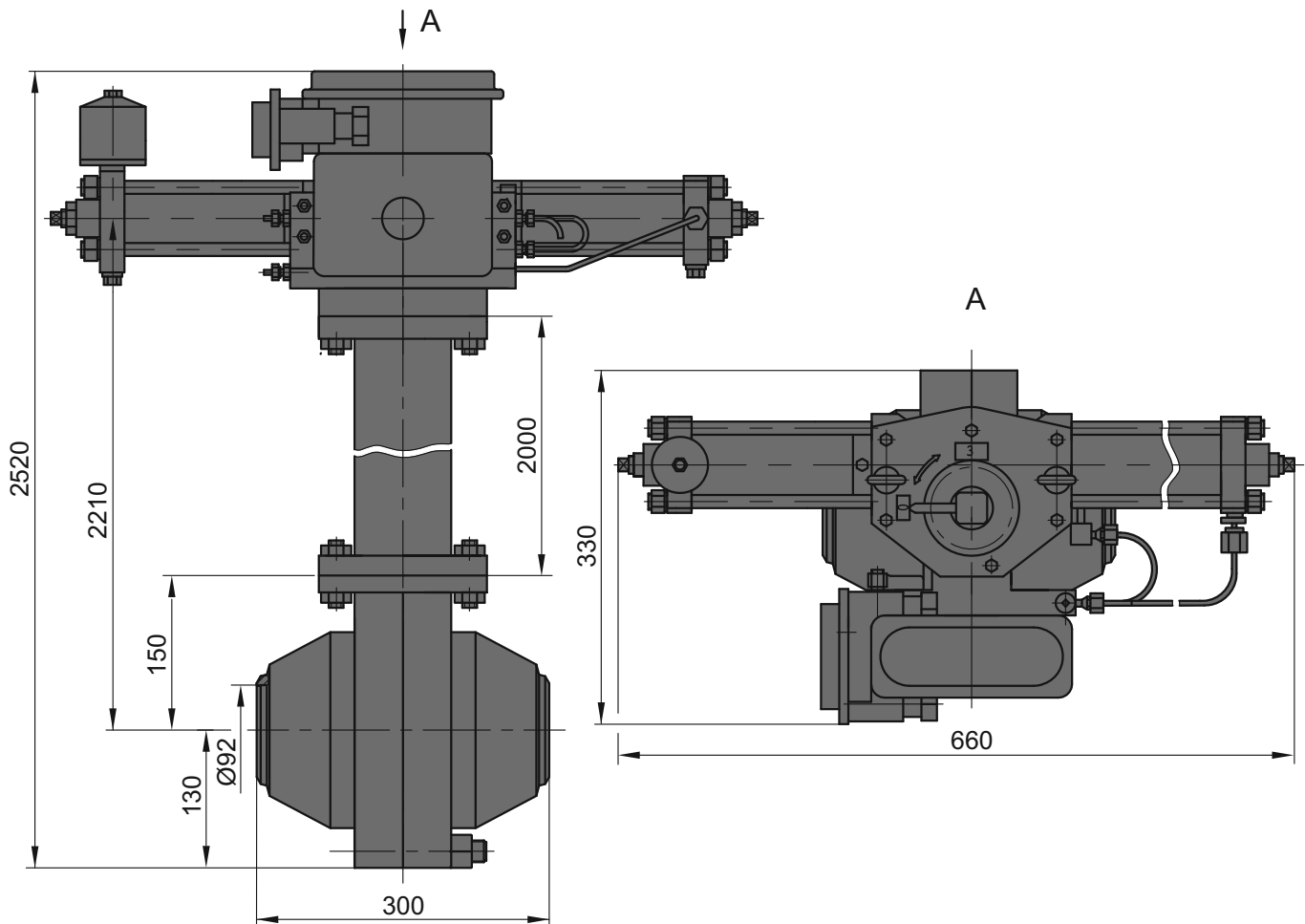

Product designation

Figure designation

Diameter Nominal, DN, mm

Pressure Nominal, PN, MPa

Actuator type

Control unit

Actuator operating medium

Pressure range of operating medium
at max. pressure differential, MPa

Control unit voltage

Connection

KSh-100-100-PP-PU-UKhL1-Pr

1.2750.209.360.00

100

10.0

pneumatic

electro-pneumatic with built-in limit switches

non-aggressive gaseous,
separate source supply

2.5...10.0

24, 110, 220 V/DC

welded end*

Material of main parts

Body

steel 09Г2С

Ball

steel 10Г2, HCP 21 μ

Stem

steel 40X, HCP 21 μ

Seat

steel 10Г2, zinc chromating 9 μ

* Pipe is beveled to the pipe specified by a Customer.

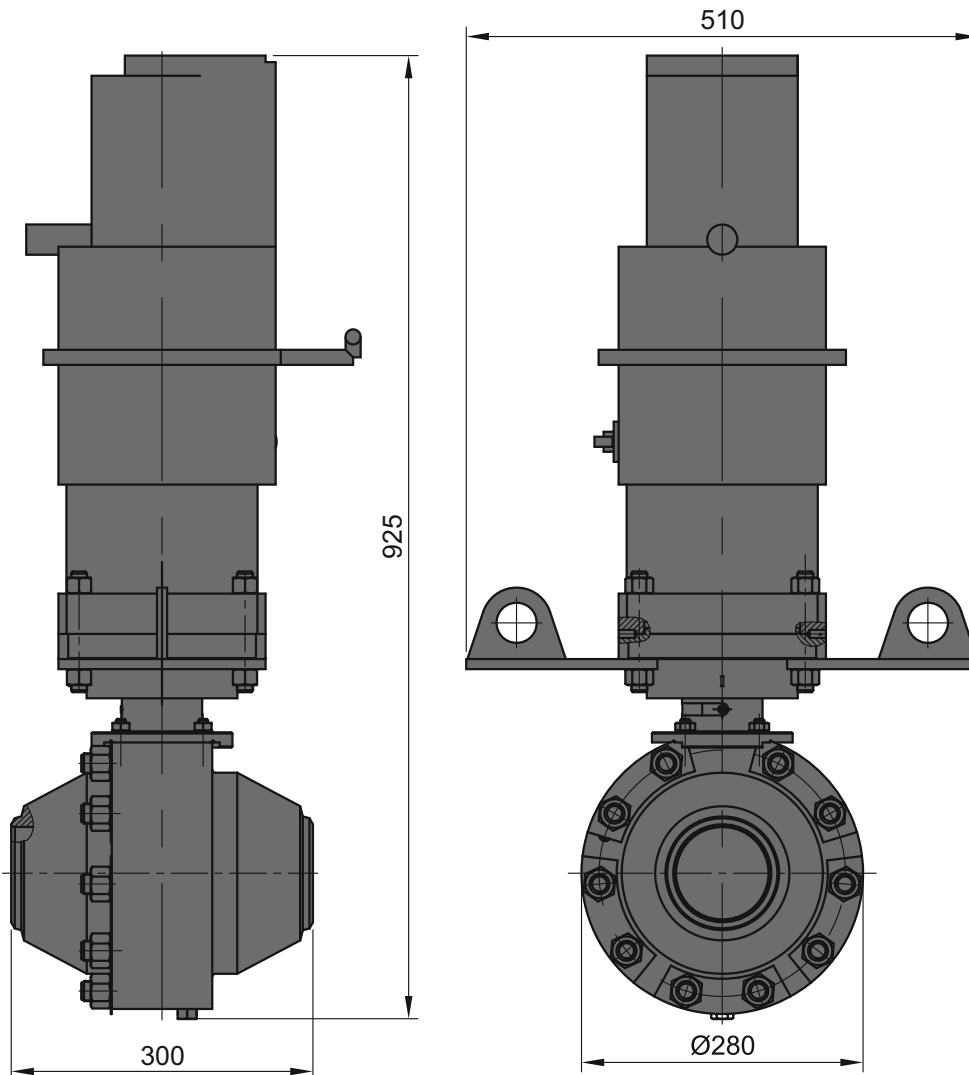

**Product designation****Figure designation**

Diameter Nominal, DN, mm
 Pressure Nominal, PN, MPa
 Actuator type
 Voltage
 Connection
 Weight, max, kg

KSh-100-100-EP-NU-UKhL1-Pr**1.2750.341.306.00**

100
 10.0
 electric
 380 V, 3 ph, N=250 W
 welded end (WE)*
 130

Material of main parts

Body	steel 09Г2С
Ball	steel 10Г2, HCP 21 μ
Stem	steel 38ХА, HCP 21 μ
Seat	steel 10Г2, zinc chromating 9 μ

* Pipe is beveled to the pipe specified by a Customer.



18 Ball Valve DN 150 PN 100 with Manual Actuator

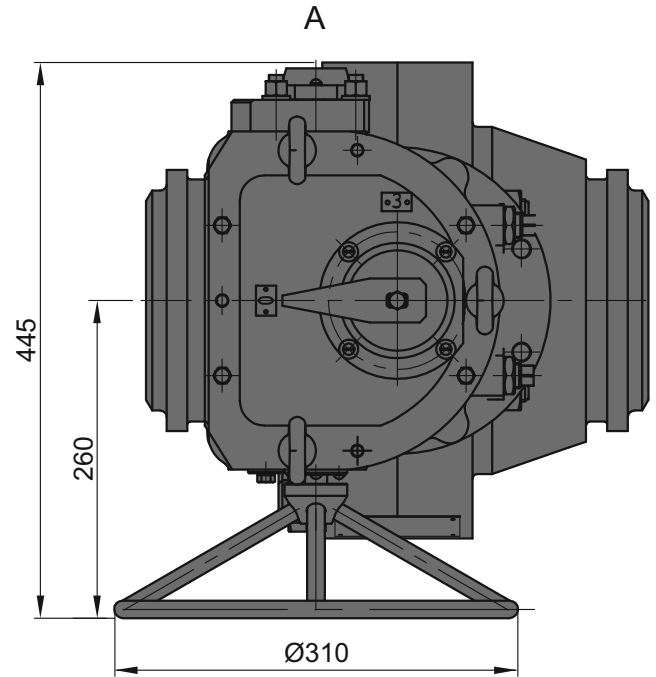
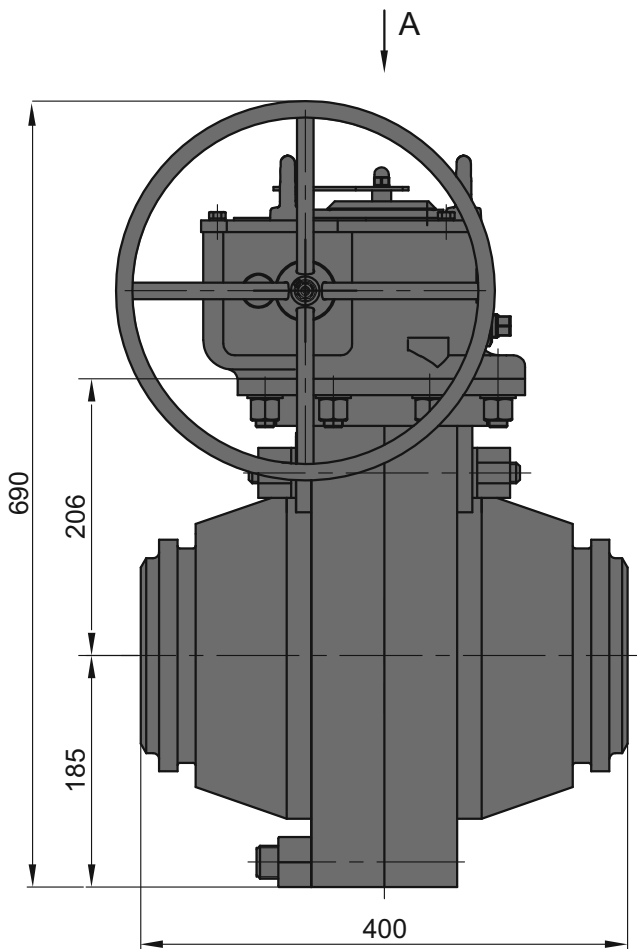

Product designation

Figure designation

Diameter Nominal, DN, mm
 Pressure Nominal, PN, MPa
 Actuator type
 Connection

KSh-150-100-RP-NU-UKhL1-Pr

1.2750.152.101.00-06

150
 10.0
 manual mechanical
 welded end (WE)*

Material of main parts

Body	steel 09Г2С
Ball	steel 10Г2, HCP 21 μ
Stem	steel 40X, HCP 21 μ
Seat	steel 10Г2, zinc chromating 9 μ

* Pipe is beveled to the pipe specified by a Customer.



Ball Valve DN 150 PN 100 with Manual Actuator for Underground Installation

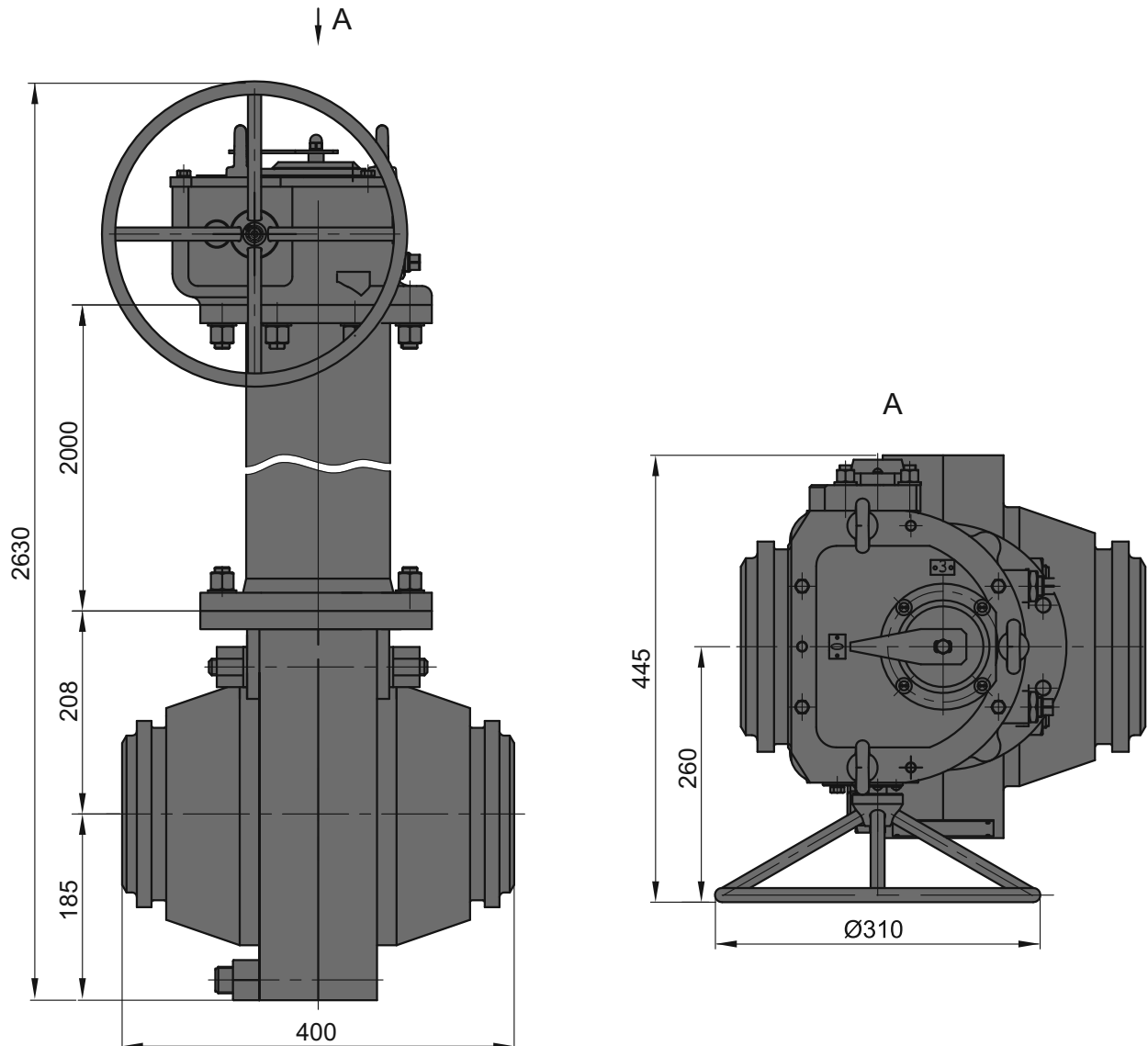

Product designation

Figure designation

Diameter Nominal, DN, mm
Pressure Nominal, PN, MPa
Actuator type
Connection

KSh-150-100-RP-PU-UKhL1-Pr

1.2750.158.101.00-02

150
10.0
manual mechanical
welded end (WE)*

Material of main parts

Body	steel 09Г2С
Ball	steel 10Г2, HCP 21 μ
Stem	steel 40X, HCP 21 μ
Seat	steel 10Г2, zinc chromating 9 μ

* Pipe is beveled to the pipe specified by a Customer.



Ball Valve DN 150 PN 100 with Pneumatic-and-Hydraulic Actuator

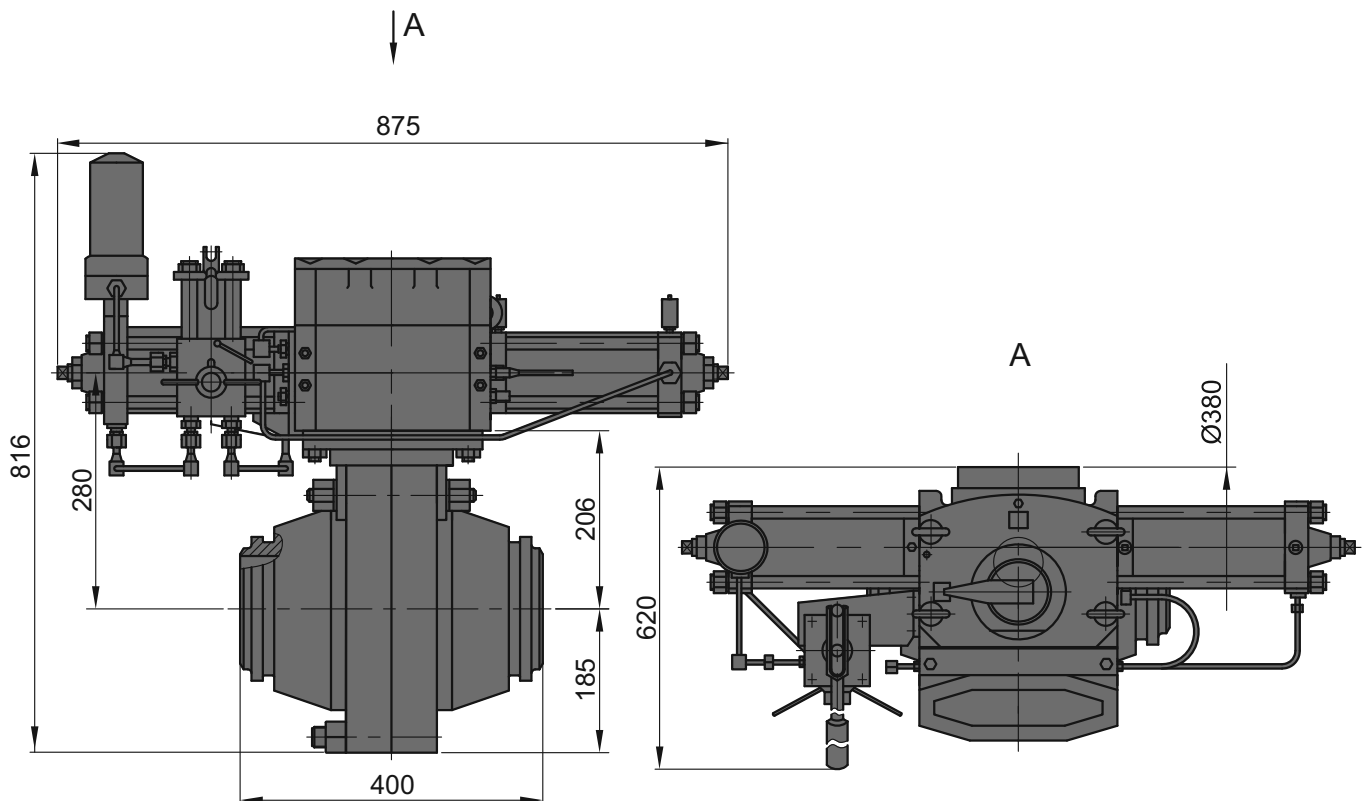

Product designation

Figure designation

Diameter Nominal, DN, mm
Pressure Nominal, PN, MPa
Actuator type

Control unit

Actuator operating medium

Pressure range of operating medium
at max. pressure differential, MPa

Control unit voltage

Connection

KSh-150-100-PGP-NU-UKhL1-Pr

1.2750.152.104.00-06

150

10.0

pneumatic-and-hydraulic
with manual override - hydraulic pump
electro-pneumatic with built-in limit switches
non-aggressive gaseous,
separate source supply

2.5...10.0

24, 110, 220 V/DC

welded end (WE)*

Material of main parts

Body

steel 09Г2С

Ball

steel10Г2, HCP 21 μ

Stem

steel 40X, HCP 21 μ

Seat

steel 10Г2, zinc chromating 9 μ

* Pipe is beveled to the pipe specified by a Customer.



Ball Valve DN 150 PN 100 with Pneumatic-and-Hydraulic Actuator for Underground Installation

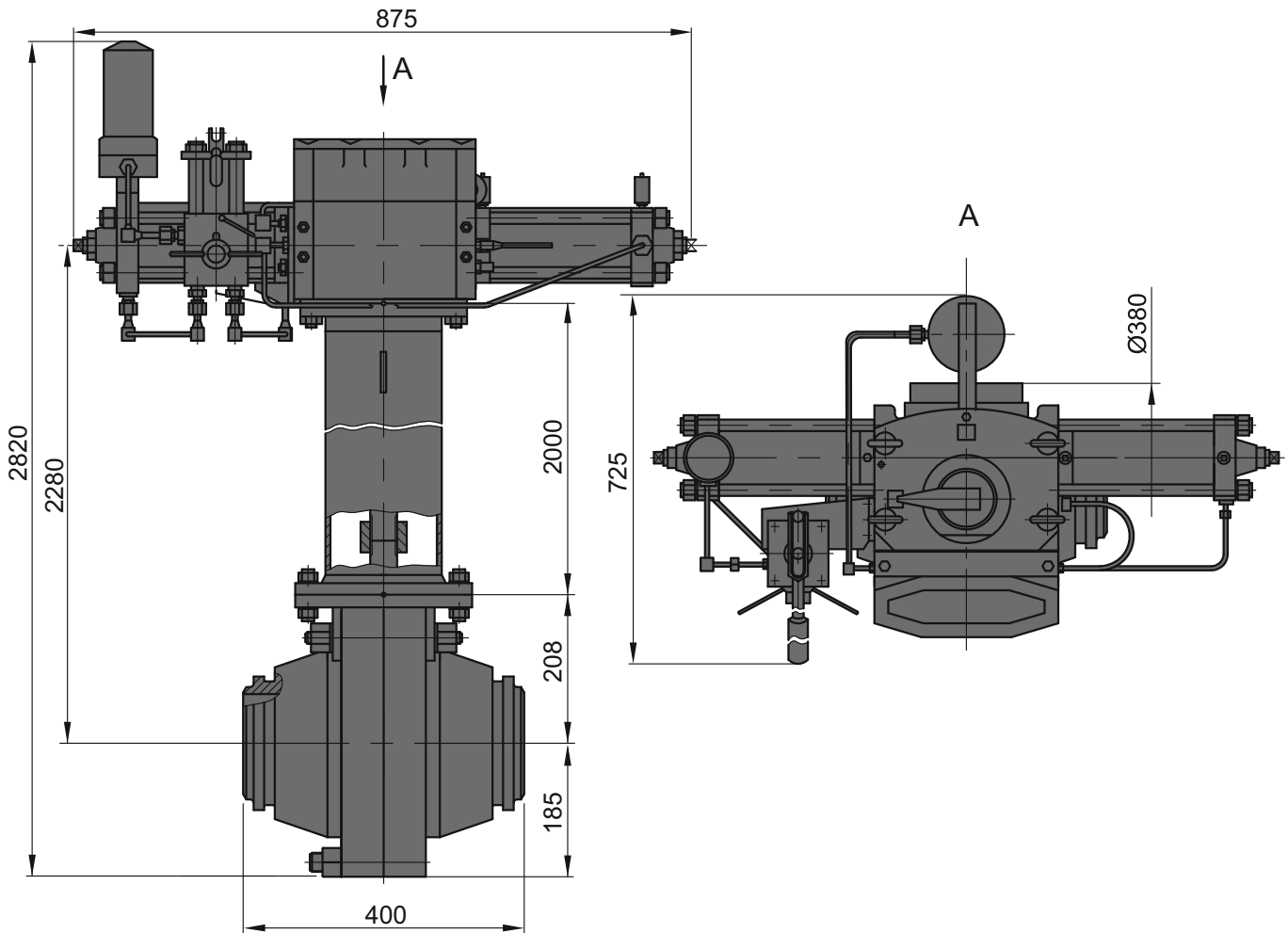

Product designation

Figure designation

Diameter Nominal, DN, mm
Pressure Nominal, PN, MPa
Actuator type

Control unit

Actuator operating medium

Pressure range of operating medium
at max. pressure differential, MPa

Control unit voltage

Connection

KSh-150-100-PGP-PU-UKhL1-Pr

1.2750.152.160.00-06

150

10.0

pneumatic-and-hydraulic
with manual override – hydraulic pump
electro-pneumatic with built-in limit switches
non-aggressive gaseous,
separate source supply

2.5...10.0

24, 110, 220 V/DC

welded end (WE)*

Material of main parts

Body

steel 09Г2С

Ball

steel10Г2, HCP 21 μ

Stem

steel 40X, HCP 21 μ

Seat

steel 10Г2, zinc chromating 9 μ

* Pipe is beveled to the pipe specified by a Customer.



Ball Valves

DN 200 – 1400 PN 80, 100

Designed for operation as shut-off devices in pipelines transporting non-aggressive natural gas and other non-aggressive media at the temperature ranged -60°C to $+80^{\circ}\text{C}$.

Tightness class A per GOST 9544.

Seat seals are made of elastomeric and composite materials.

Welded end connection (flanged is possible).

Climatic version is for areas with temperate and cold climate (-60°C thru $+45^{\circ}\text{C}$).

Ball valves are available with a variety of operator options: manual, pneumatic and pneumatic-and-hydraulic.

Over-ground and underground installation.

Ball valves can be completed with emergency shut off automatic device (for DN 400 - 1400).

Manually operated ball valves can be installed in any position, and pneumatically and pneumatically and hydraulically operated ball valves are installed in horizontal pipelines with actuator facing upward. Vertical axial deviation shall be 10° max.

The average service life before overhaul is no more than 40 years.

The Company reserves the right to make design changes to improve it, while minor changes may not be shown in the Catalog.

Design Features:

- Valve is a stamped two-piece, split body; the design enables to reduce gas escaping into the environment.
- Closure member is sealed with a high wear/erosion resistant elastomeric material.
- Both seats are tightened to the ball ensuring high leakproof closure member.
- "Trunnion mounted ball" with self-lubricating bearings made of metal-fluoroplastic that makes easy valves control.
- Pneumatically and hydraulically actuated ball valves are furnished with manual overrides (hydraulic pumps).
- "No tank" actuator design greatly reduces hydraulic liquid volume in the actuator hydraulic system.
- Pneumatic-and-hydraulic actuators are filled with hydraulic liquid.
- Ball valve control units have integrated terminal boxes, and limit switches; and they do not require additional piping.
- Control voltage is 24V, 110V and 220V.
- Ball valves can be furnished with electric actuators.
- Ball valves for underground service have corrosion-resistant polymer coating.



DN 700 PN 100



DN 1400 PN 100

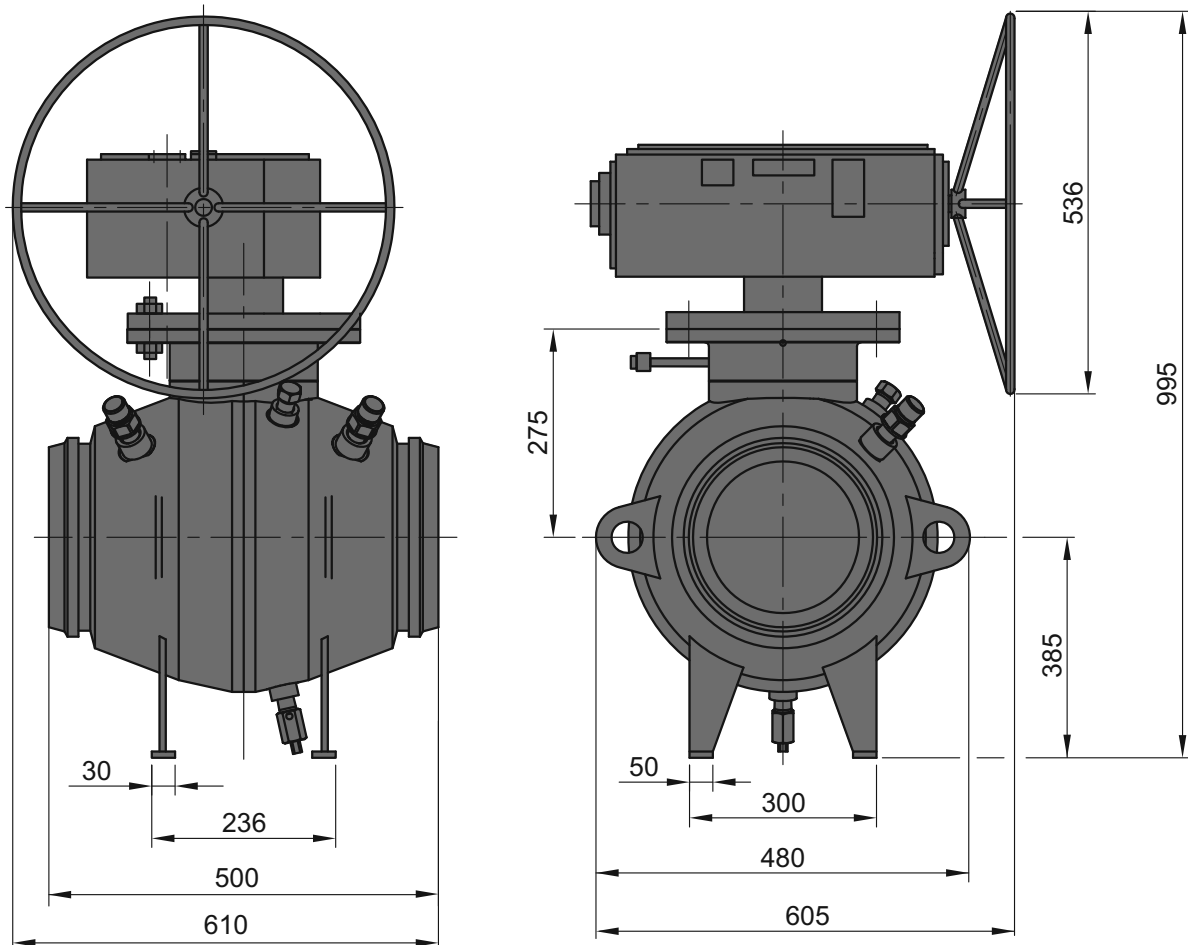

**Product designation****Figure designation**

Diameter Nominal, DN, mm

Pressure Nominal, PN, MPa

Actuator type

Connection

Weight, max, kg

KSh-200-100-RP-NU-UKhL-Pr**A.1.2750.150.101.00-06**

200

10.0

manual mechanical

welded end (WE)*

300

Material of main parts

Body

steel 09Г2С

Ball

steel 20ГЛ, HCP 30 μ

Stem

steel 38 XA, HCP 21 μ

Seat (cover)

steel 10Г2, zinc chromating 9 μ

* Pipe is beveled to the pipe specified by a Customer.



Ball Valve DN 200 PN 100 with Pneumatic-and-Hydraulic Actuator

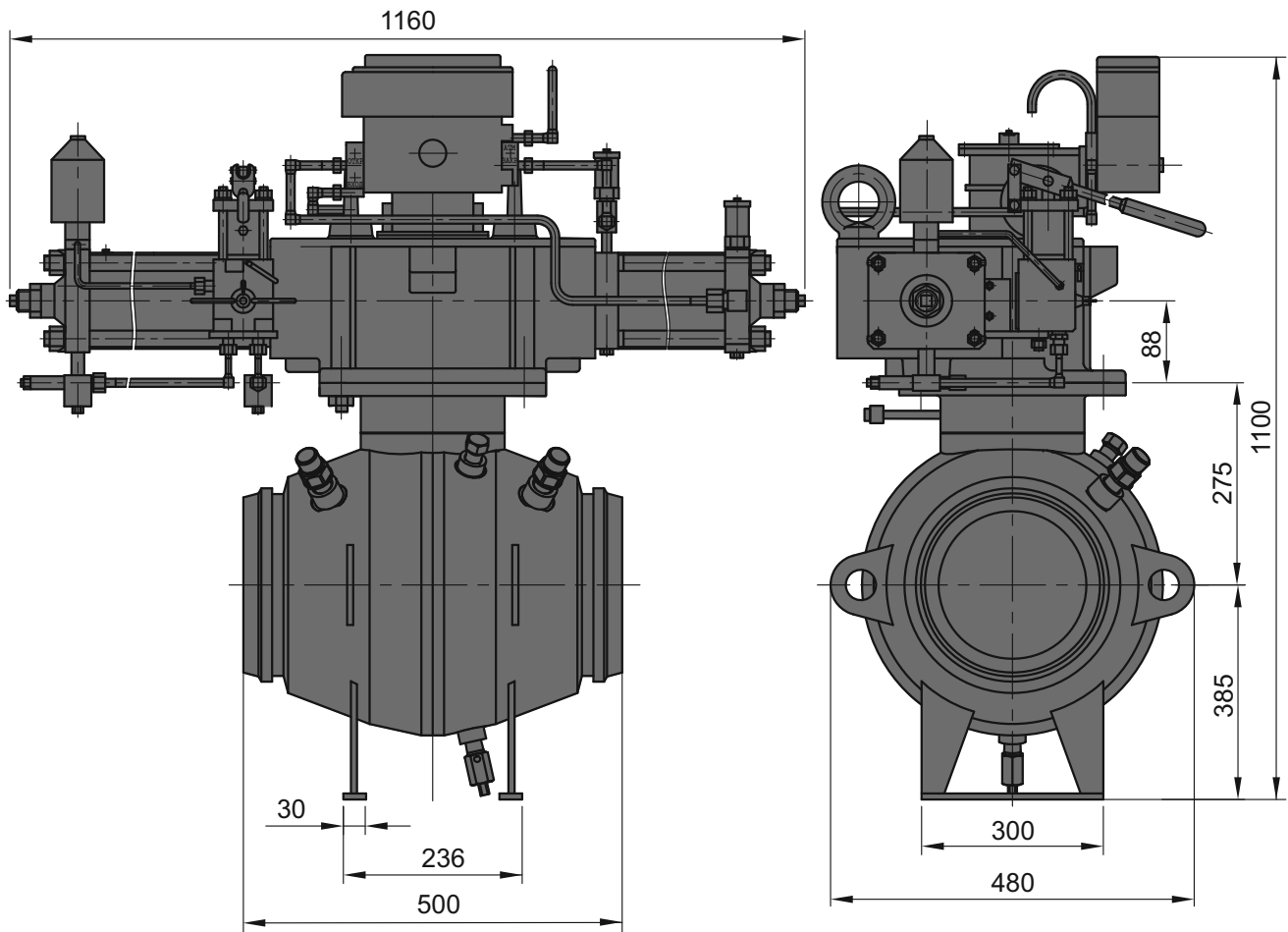

Product designation

Figure designation

Diameter Nominal, DN, mm

Pressure Nominal, PN, MPa

Actuator type

Control unit

Actuator operating medium

Pressure range of operating medium

at max. pressure differential, MPa

Control unit voltage

Connection

Weight, max, kg

KSh-200-100-PGP-NU-UKhL1-Pr

A.1.2750.150.104.00-06

200

10.0

pneumatic-and-hydraulic with manual
override – hydraulic pump

electro-pneumatic with built-in limit switches

non-aggressive gaseous,
separate source supply

2.5...10.0

24, 110, 220 V/DC

welded end (WE)*

390

Material of main parts

Body

steel 09Г2С

Ball

steel 20ГЛ, HCP 30 μ

Stem

steel 38ХА, HCP 21 μ

Seat

steel 10Г2, zinc chromating 9 μ

* Pipe is beveled to the pipe specified by a Customer.



Ball Valve DN 200 PN 100 with Pneumatic-and-Hydraulic Actuator for Underground Installation

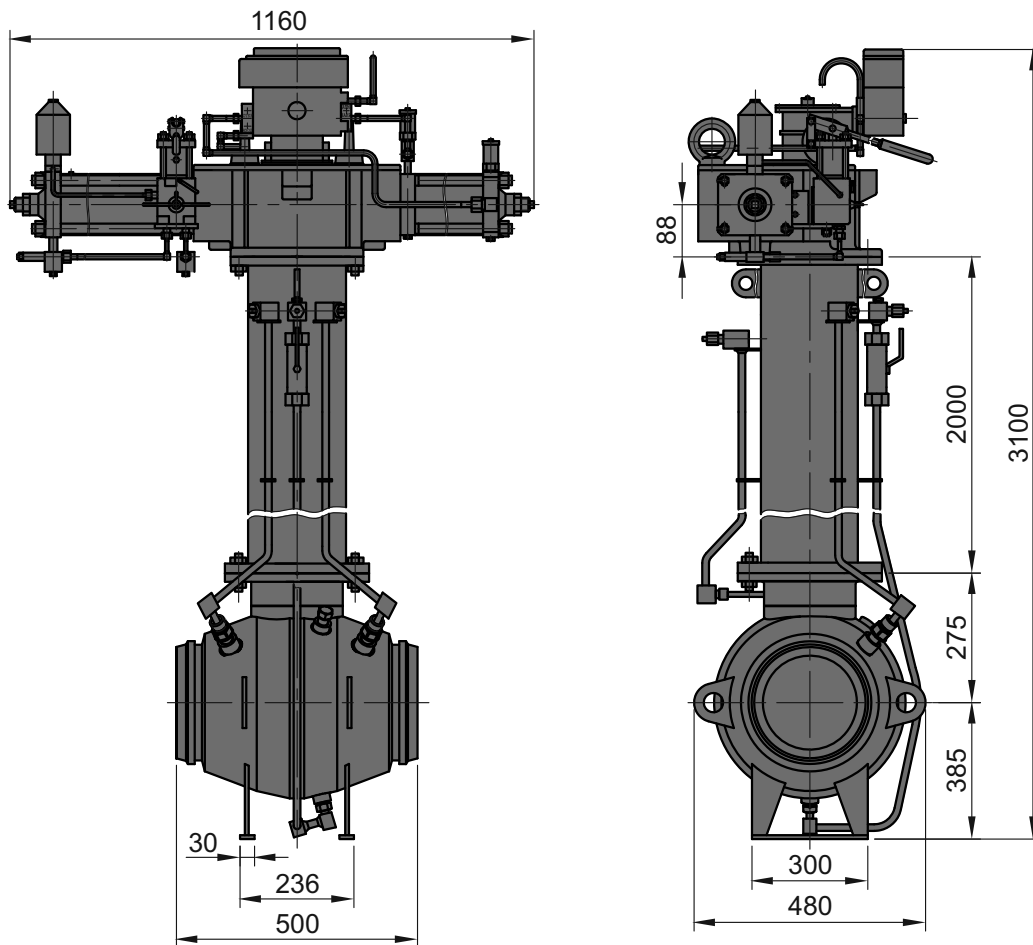

Product designation

Figure designation

Diameter Nominal, DN, mm

Pressure Nominal, PN, MPa

Actuator type

Control unit

Actuator operating medium

Pressure range of operating medium

at max. pressure differential, MPa

Control unit voltage

Connection

Weight, max, kg

KSh-200-100-PGP-PU-UKhL1-Pr

A.1.2750.150.160.00

200

10.0

pneumatic-and-hydraulic with manual
override – hydraulic pump

electro-pneumatic with built-in limit switches

non-aggressive gaseous,
separate source supply

2.5...10.0

24, 110, 220 V/DC

welded end (WE)*

615

Material of main parts

Body

steel 09Г2С

Ball

steel 20ГЛ, HCP 30 μ

Stem

steel 45ХГМА, HCP 21 μ

Seat

steel 10Г2, zinc chromating 9 μ

* Pipe is beveled to the pipe specified by a Customer.



Ball Valve DN 300 x DN 250 PN 100 with Manual Actuator per API-6D

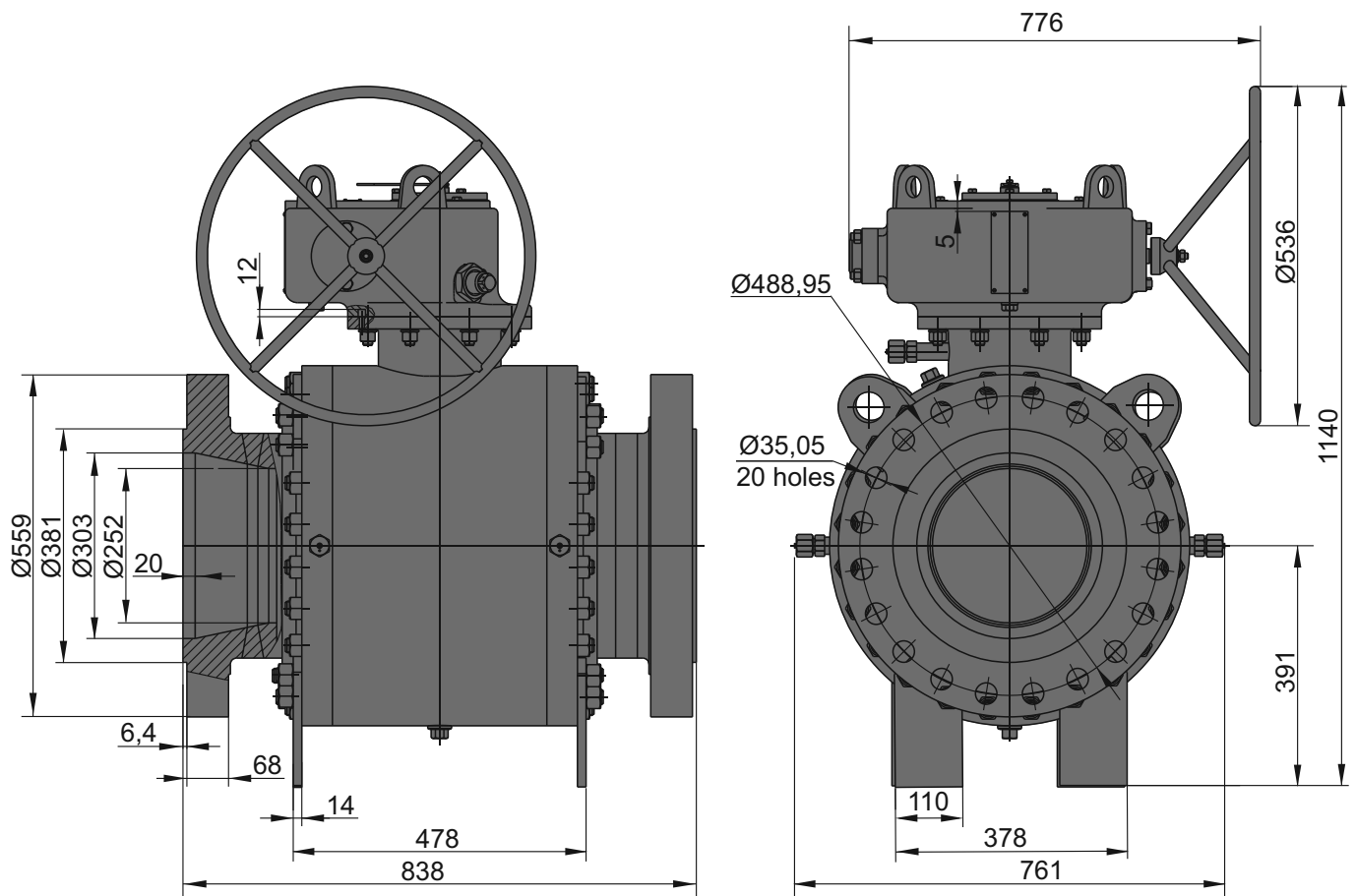

Product designation

Figure designation

Diameter Nominal, DN, mm

Pressure Nominal, PN, MPa

Ambient temperature, °C

Working medium temperature, °C

Actuator type

Connection

Weight, max, kg

KSh-300x250-100-RP-NU-U1-F

M.1.2750.477.201.00

300x250

10.0

from -29 to +48

from -29 to +80

manual mechanical

flanged

1130

Material of main parts

Body

steel ASTM A350LF2, zinc chromating 24 μ

Ball

steel ASTM A350LF2, HCP 21 μ

Stem

steel 4140 ASME SA-29M, HCP 21 μ

Seat

steel ASTM A350LF2, zinc chromating 9 μ

Seal

polyurethane PPU-1 TU RB 700069297.008-2000

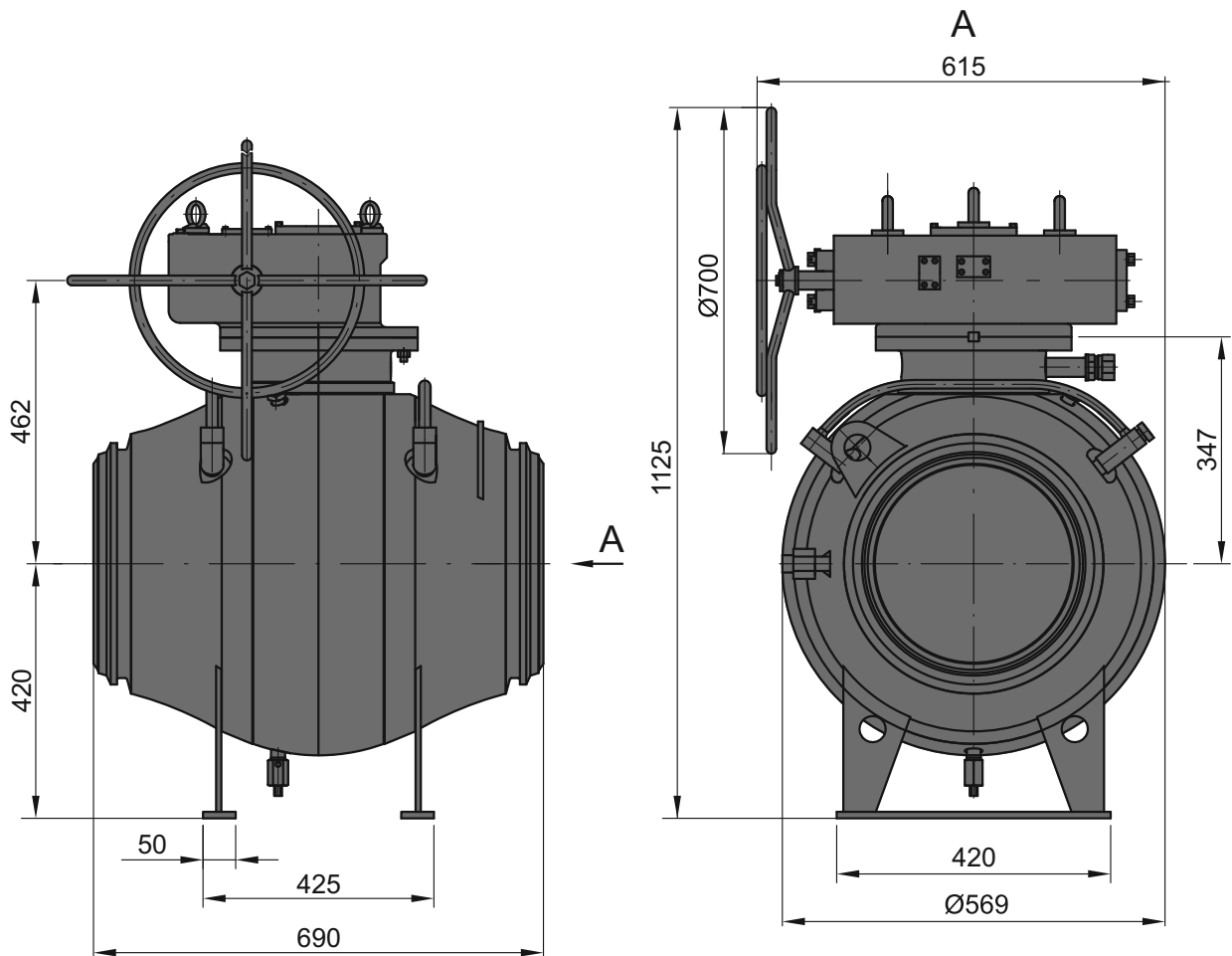

**Product designation****Figure designation**

Diameter Nominal, DN, mm
 Pressure Nominal, PN, MPa
 Actuator type
 Connection
 Weight, max, kg

KSh-300-100-RP-NU-UKhL1-Pr**1.2750.284.101.00**

300
 10.0
 manual mechanical
 welded end*
 527

Material of main parts

Body	steel 09Г2С, zinc chromating 24 μ
Ball	steel 20ГЛ, HCP 21 μ
Stem	steel 38 XA, HCP 21 μ
Seat	steel 09Г2С, zinc chromating 9 μ

* Pipe is beveled to the pipe specified by a Customer.



Ball Valve DN 300 PN 100 with Manual Actuator for Underground Installation

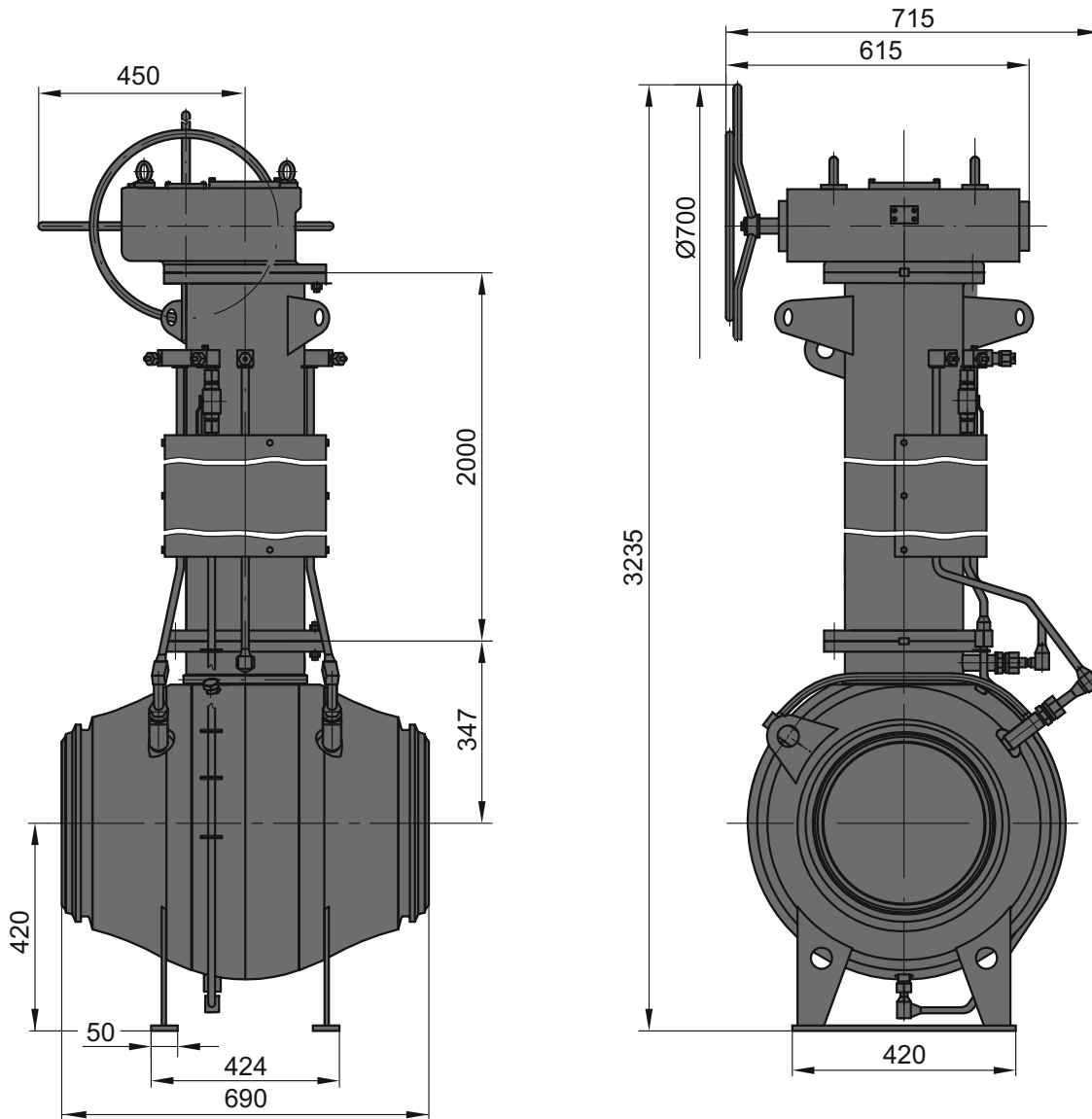

Product designation

Figure designation

Diameter Nominal, DN, mm
Pressure Nominal, PN, MPa
Actuator type
Connection
Weight, max, kg

KSh-300-100-RP-PU-UKhL1-Pr

A.1.2750.276.101.00

300
10.0
manual mechanical
welded end*
787

Material of main parts

Body	steel 09Г2С, zinc chromating 24 μ
Ball	steel 20ГЛ, HCP 21 μ
Stem	steel 38 XA, HCP 21 μ
Seat	steel 09Г2С, zinc chromating 9 μ

* Pipe is beveled to the pipe specified by a Customer.



Ball Valve DN 300 PN 100 with Pneumatic-and-Hydraulic Actuator

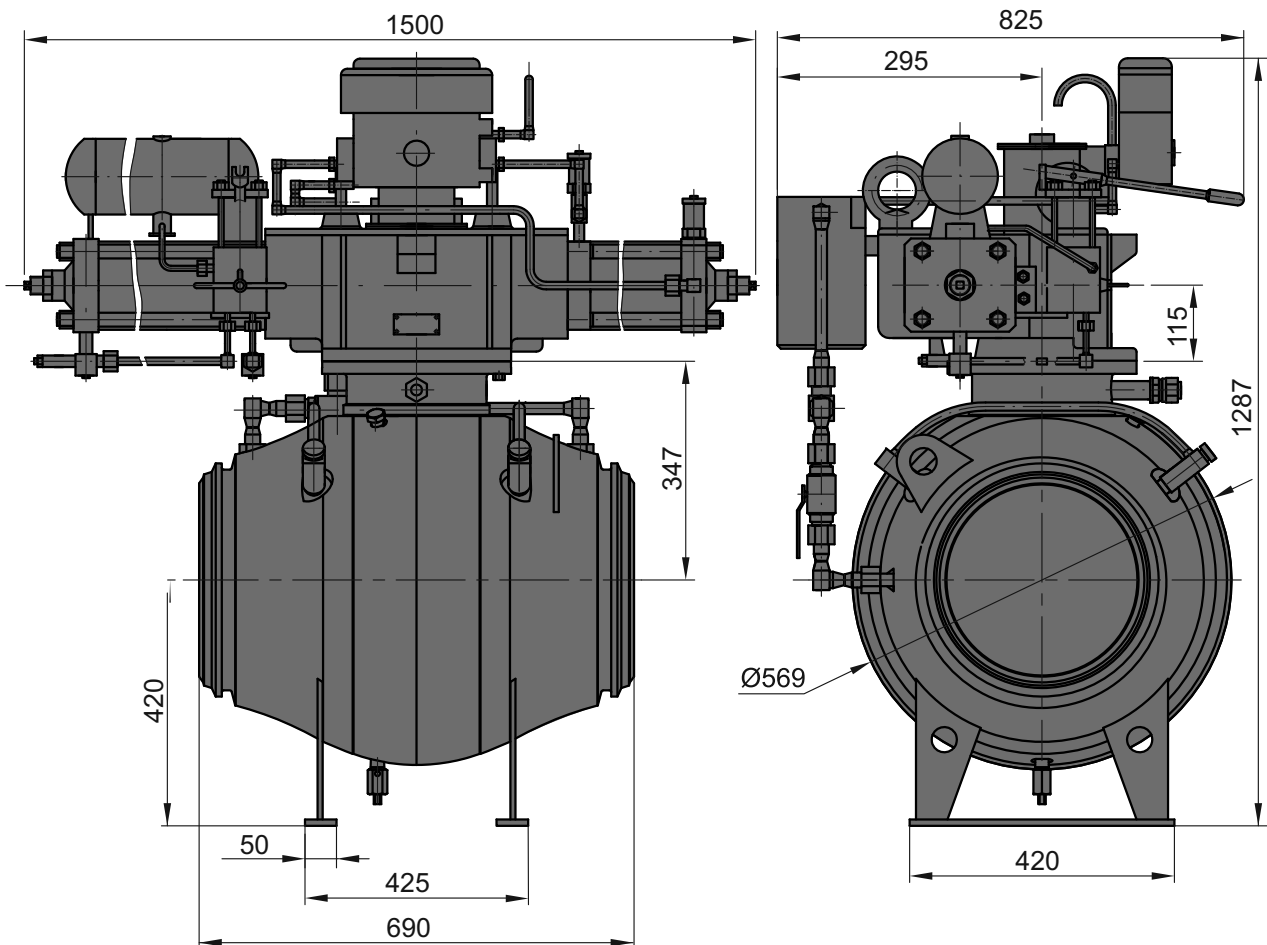

Product designation

Figure designation

Diameter Nominal, DN, mm
Pressure Nominal, PN, MPa
Actuator type

Control unit

Actuator operating medium

Pressure range of operating medium
at max. pressure differential, MPa

Control unit voltage

Connection

Weight, max, kg

KSh-300-100-PGP-NU-UKhL1-Pr

1.2750.284.104.00

300

10.0

pneumatic-and-hydraulic
with manual override – hydraulic pump
electro-pneumatic with unit of limit switches
supply from pipeline

2.5...10.0

24, 110, 220 V/DC

welded end (WE)*

600

Material of main parts

Body

Ball

Stem

Seat

steel 09Г2С zinc chromating 24 μ

steel 20ГЛ, HCP 21 μ

steel 38ХА, HCP 21 μ

steel 09Г2С, zinc chromating 9 μ

*Pipe is beveled to the pipe specified by a Customer.



Ball Valve DN 300 PN 100 with Pneumatic-and-Hydraulic Actuator for Underground Installation

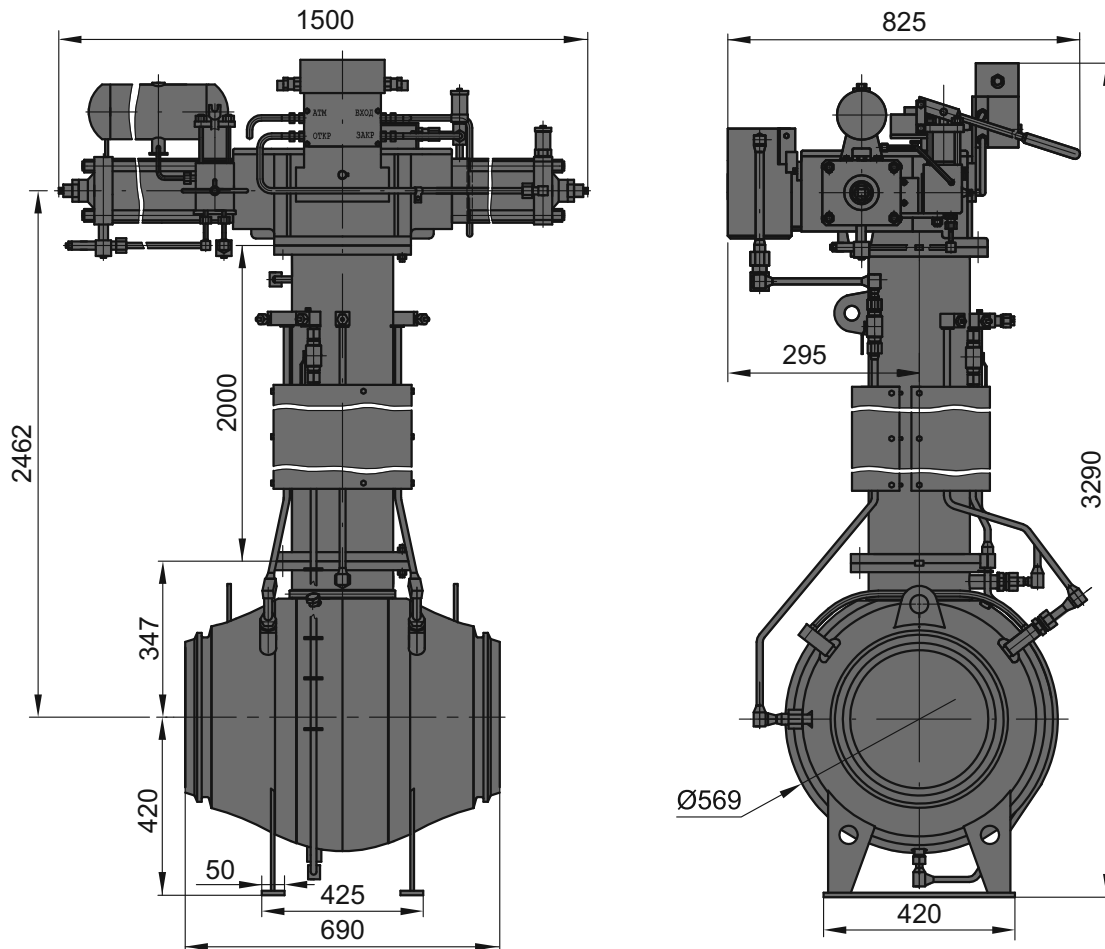

Product designation

Figure designation

Diameter Nominal, DN, mm
Pressure Nominal, PN, MPa
Actuator type

Control unit

Actuator operating medium
Pressure range of operating medium
at max. pressure differential, MPa
Control unit voltage
Connection
Weight, max, kg

KSh-300-100-PGP-PU-UKhL1-Pr

A.1.2750.194.160.00

300
10.0
pneumatic-and-hydraulic
with manual override – hydraulic pump
electro-pneumatic with unit of limit switches
supply from pipeline

2.5...10.0
24, 110, 220 V/DC
welded end (WE)*
920

Material of main parts

Body	steel 09Г2С zinc chromating 24 μ
Ball	steel 20ГЛ, HCP 21 μ
Stem	steel 38ХА, HCP 21 μ
Seat	steel 09Г2С, zinc chromating 9 μ

* Pipe is beveled to the pipe specified by a Customer.

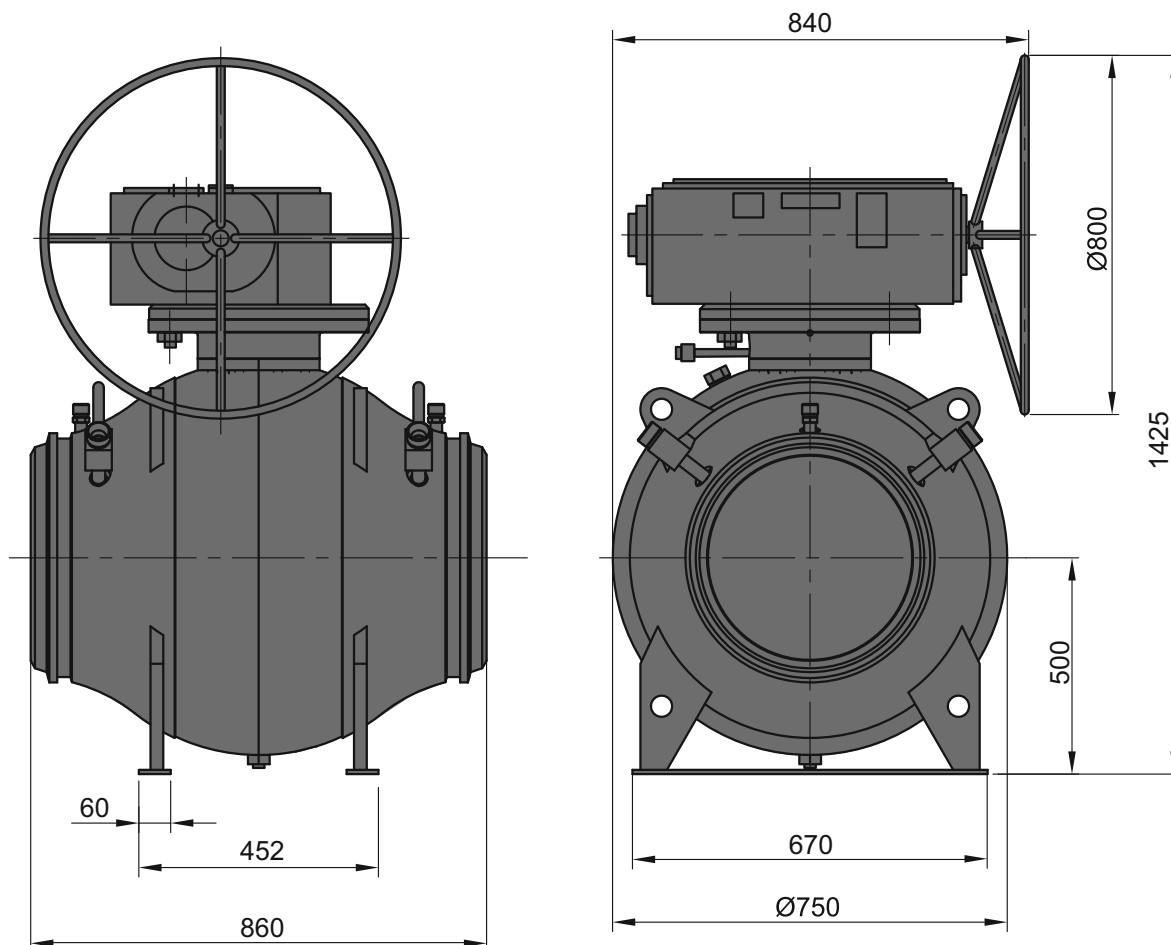

**Product designation****Figure designation**

Diameter Nominal, DN, mm

Pressure Nominal, PN, MPa

Actuator type

Connection

Weight, max, kg

KSh-400-100-RP-NU-UKhL1-Pr**1.2750.285.101.00**

400

10.0

manual mechanical

welded end*

1101

Material of main parts

Body

steel 09Г2С, zinc chromating 24 μ

Ball

steel 20ГЛ, HCP 30 μ

Stem

steel 38 XA, HCP 21 μ

Seat

steel 09Г2С, zinc chromating 9 μ

* Pipe is beveled to the pipe specified by a Customer.



Ball Valve DN 400 PN 100 with Pneumatic-and-Hydraulic Actuator

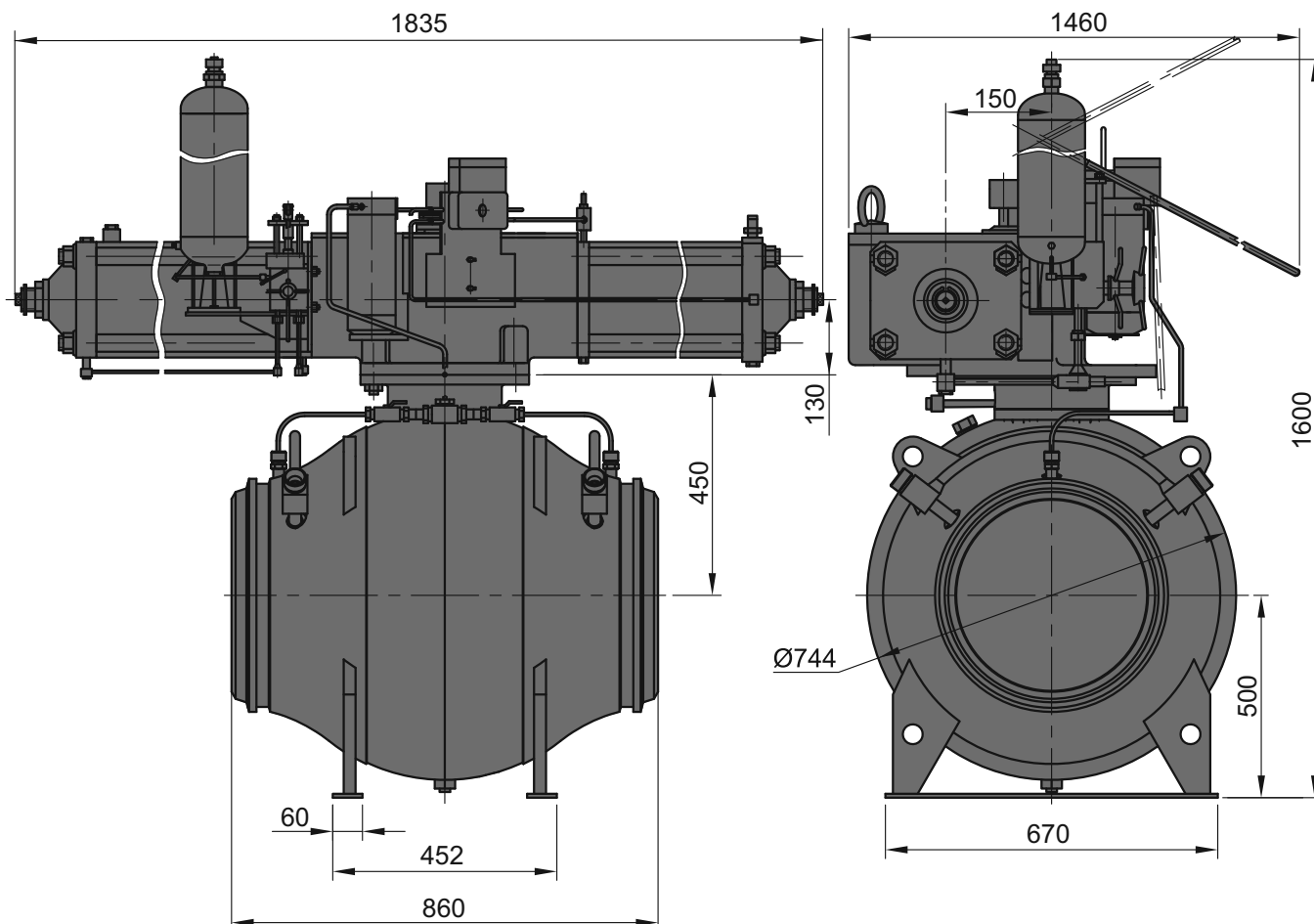

Product designation

Figure designation

Diameter Nominal, DN, mm
Pressure Nominal, PN, MPa
Actuator type

Control unit

Actuator operating medium
Pressure range of operating medium
at max. pressure differential, MPa
Control unit voltage
Connection
Weight, max, kg

KSh-400-160-PGP-NU-UKhL1-Pr

1.2750.285.104.00

400
10.0
pneumatic-and-hydraulic
with manual override – hydraulic pump
electro-pneumatic with unit of limit switches
supply from pipeline
2.5...10.0
24, 110, 220 V/DC
welded end (WE)*
1250

Material of main parts

Body	steel 09Г2С, zinc chromating 24 μ
Ball	steel 20ГЛ, HCP 30 μ
Stem	steel 38ХА, HCP 21 μ
Seat	steel 09Г2С, zinc chromating 9 μ

* Pipe is beveled to the pipe specified by a Customer.



Ball Valve DN 400 PN 100 with Pneumatic-and-Hydraulic Actuator for Underground Installation

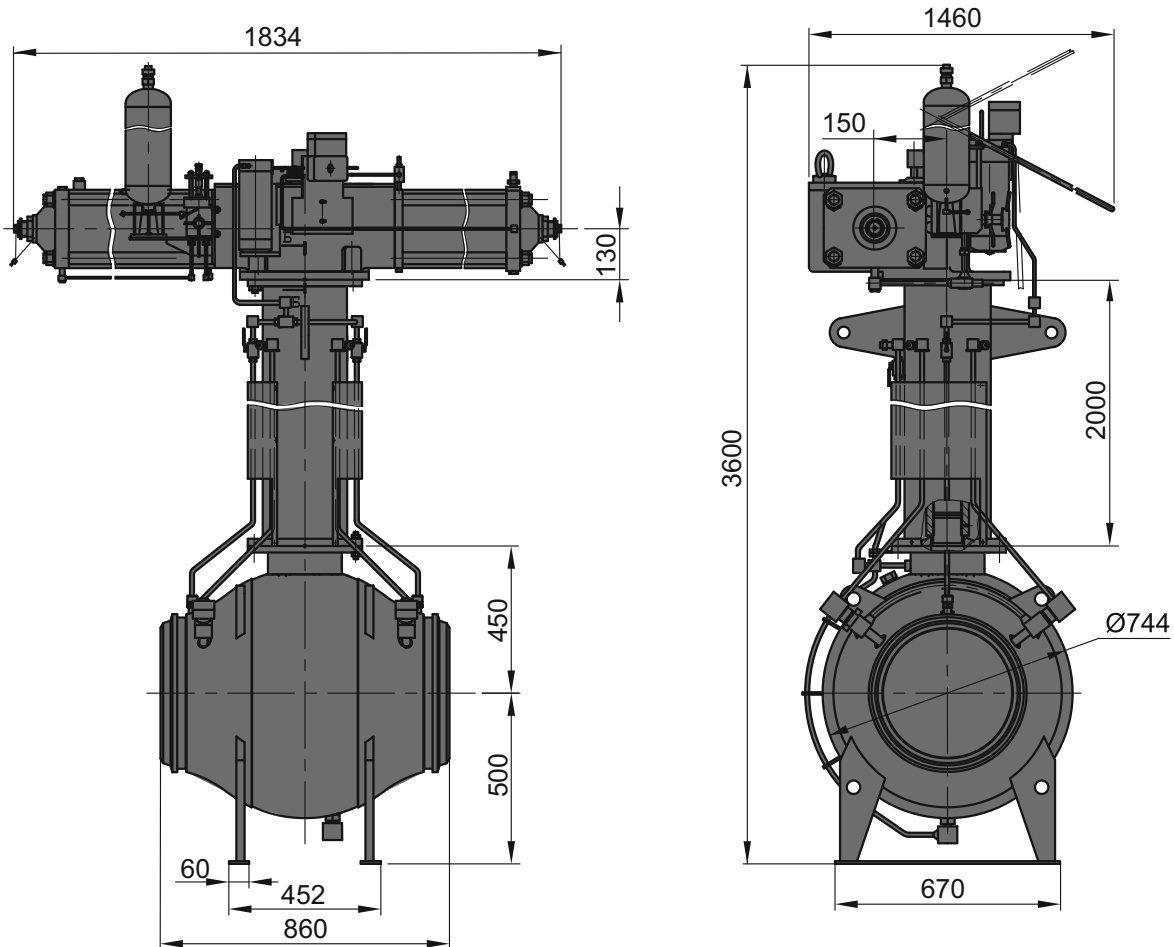

Product designation

Figure designation

Diameter Nominal, DN, mm
Pressure Nominal, PN, MPa
Actuator type

Control unit

Actuator operating medium

Pressure range of operating medium
at max. pressure differential, MPa

Control unit voltage

Connection

Weight, max, kg

KSh-400-160-PGP-PU-UKhL1-Pr

A.1.2750.161.104.00

400

10.0

pneumatic-and-hydraulic
with manual override – hydraulic pump
electro-pneumatic with unit of limit switches
supply from pipeline

2.5...10.0

24, 110, 220 V/DC

welded end (WE)*

1595

Material of main parts

Body

steel 09Г2С, zinc chromating 24 μ

Ball

steel 20ГЛ, HCP 30 μ

Stem

steel 38ХА, HCP 21 μ

Seat

steel 09Г2С, zinc chromating 9 μ

* Pipe is beveled to the pipe specified by a Customer.

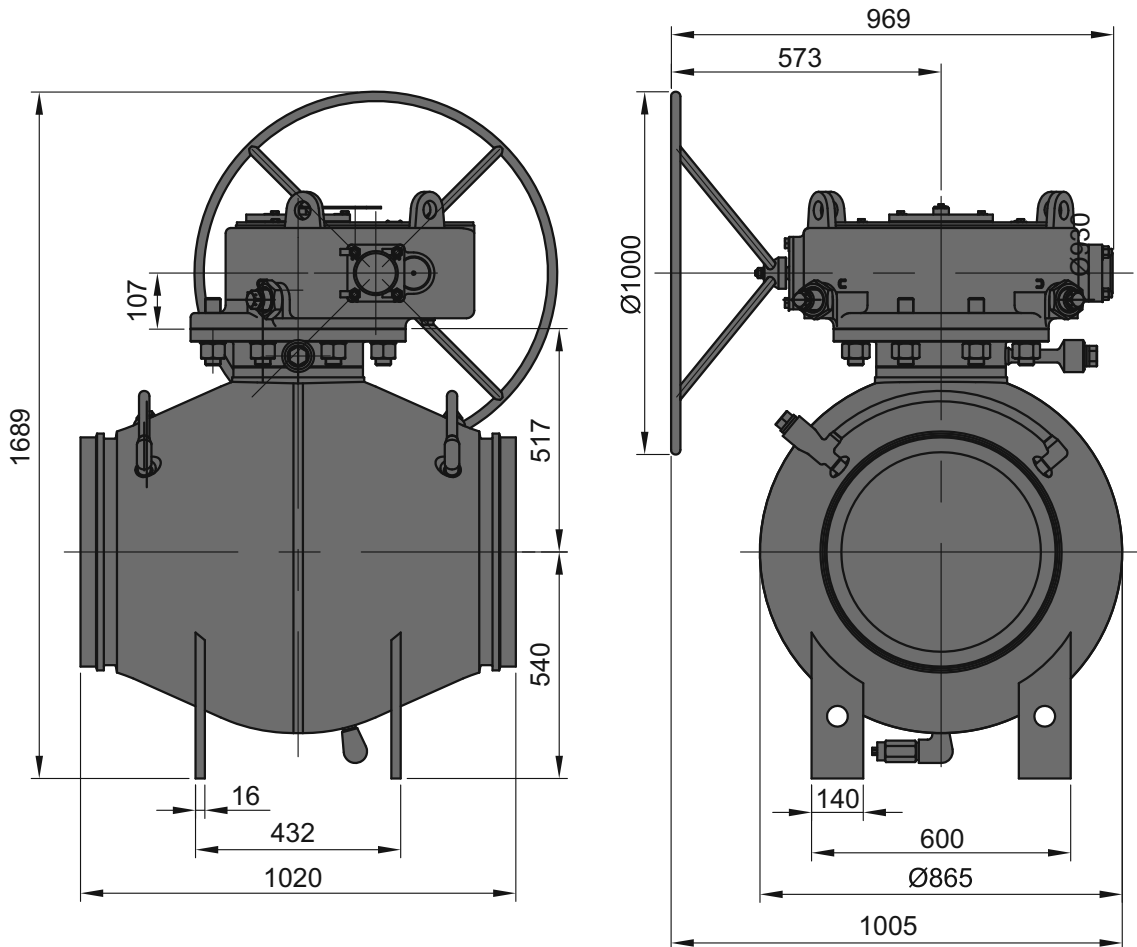

**Product designation****Figure designation**

Diameter Nominal, DN, mm
 Pressure Nominal, PN, MPa
 Actuator type
 Connection
 Weight, max, kg

KSh-500-100-RP-NU-UKhL1-Pr**1.2750.315.101.00**

500
 10.0
 manual mechanical
 welded end (WE)*
 1834

Material of main parts

Body	steel 09Г2С
Ball	steel 20ГЛ, HCP 30 μ
Stem	steel 40X, HCP 21 μ
Seat (cover)	steel 09Г2С, zinc chromating 9 μ

* Pipe is beveled to the pipe specified by a Customer.



Ball Valve DN 500 PN 100 with Manual Actuator for Underground Installation

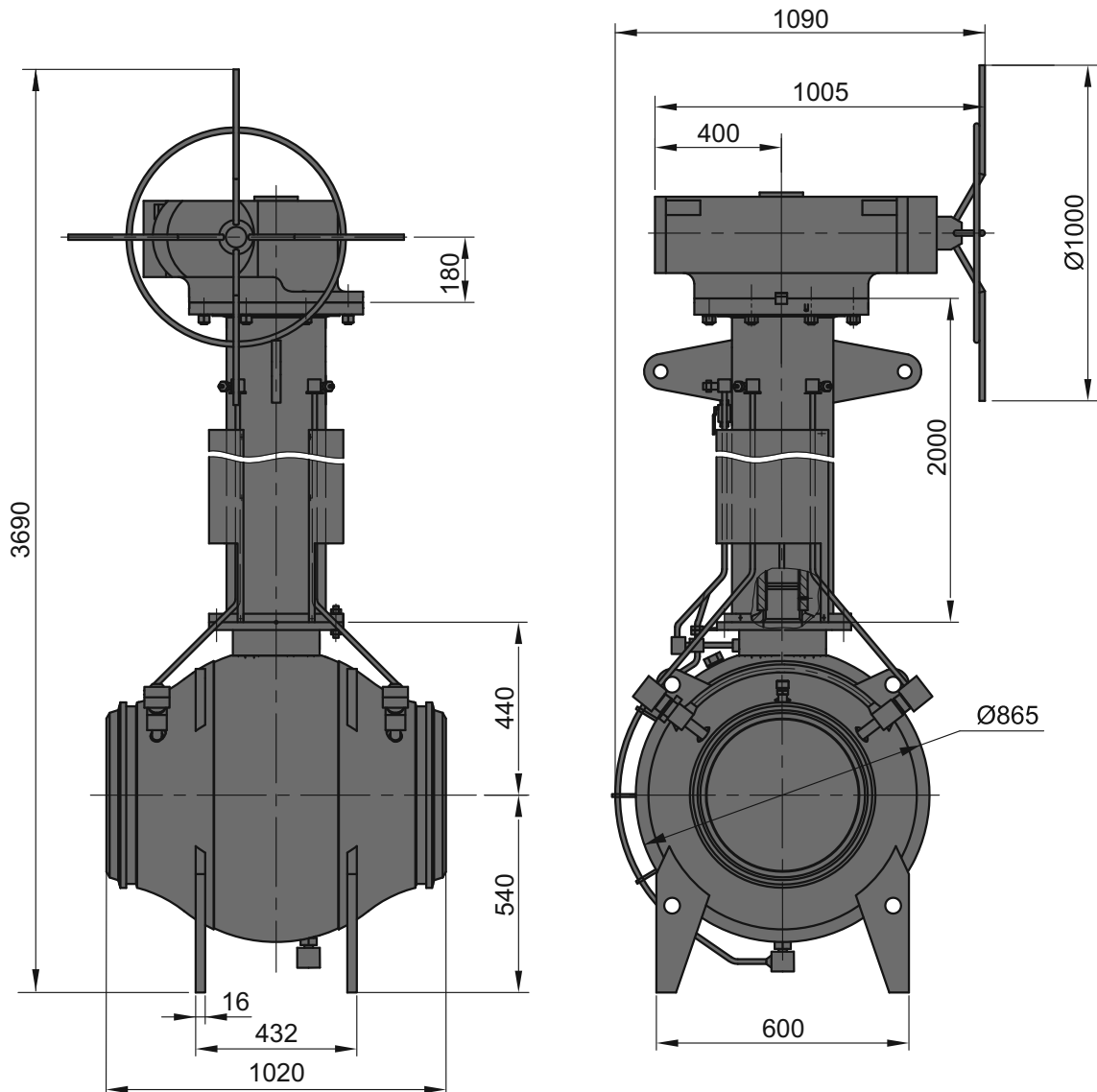

Product designation

Figure designation

Diameter Nominal, DN, mm
Pressure Nominal, PN, MPa
Actuator type
Connection
Weight, max, kg

KSh-500-100-RP-PU-UKhL1-Pr

1.2750.315.155.00

500
10.0
manual mechanical
welded end (WE)*
2430

Material of main parts

Body	steel 09Г2С, zinc chromating 24 μ
Ball	steel 20ГЛ, HCP 30 μ
Stem	steel 40X, HCP 21 μ
Seat (cover)	steel 09Г2С, zinc chromating 9 μ

* Pipe is beveled to the pipe specified by a Customer.



Ball Valve DN 500 PN 100 with Pneumatic-and-Hydraulic Actuator

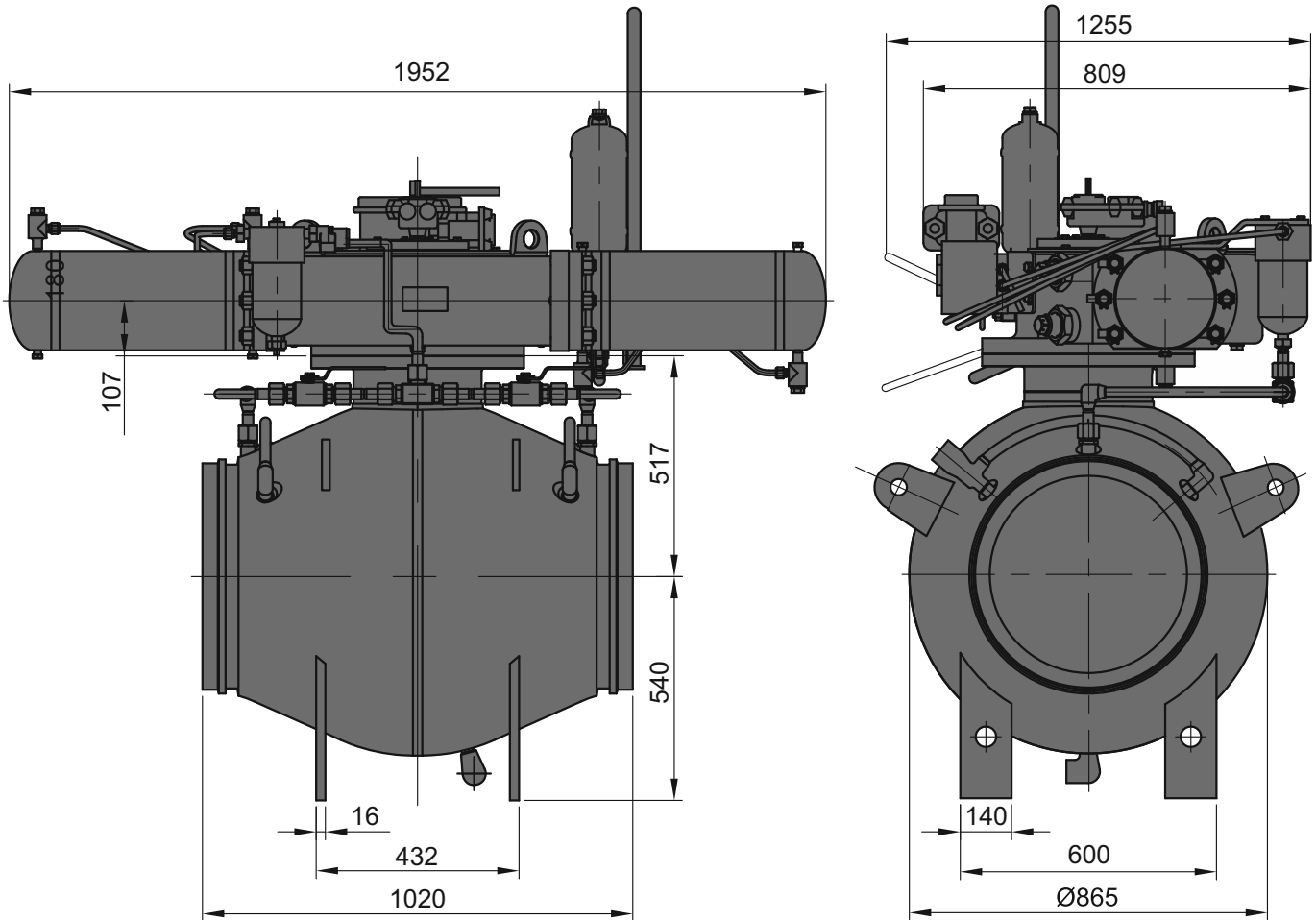

Product designation

Figure designation

Diameter Nominal, DN, mm

Pressure Nominal, PN, MPa

Actuator type

Actuator operating medium

Pressure range of operating medium
at pressure differential on valve
closure member up to 2.0 MPa, MPa

Control unit voltage

Connection

Weight, max, kg

KSh-500-100-PGP-NU-UKhL1-Pr

1.2750.315.104.00

500

10.0

pneumatic-and-hydraulic
supply from pipeline

2.5...10.0

24, 110, 220 V/DC

welded end (WE)*

2078

Material of main parts

Body

steel 09Г2С

Ball

steel 20ГЛ, HCP 30 μ

Stem

steel 40X, HCP 21 μ

Seat

steel 09Г2С, zinc chromating 9 μ

* Pipe is beveled to the pipe specified by a Customer.



Ball Valve DN 500 PN 100 with Pneumatic-and-Hydraulic Actuator for Underground Installation

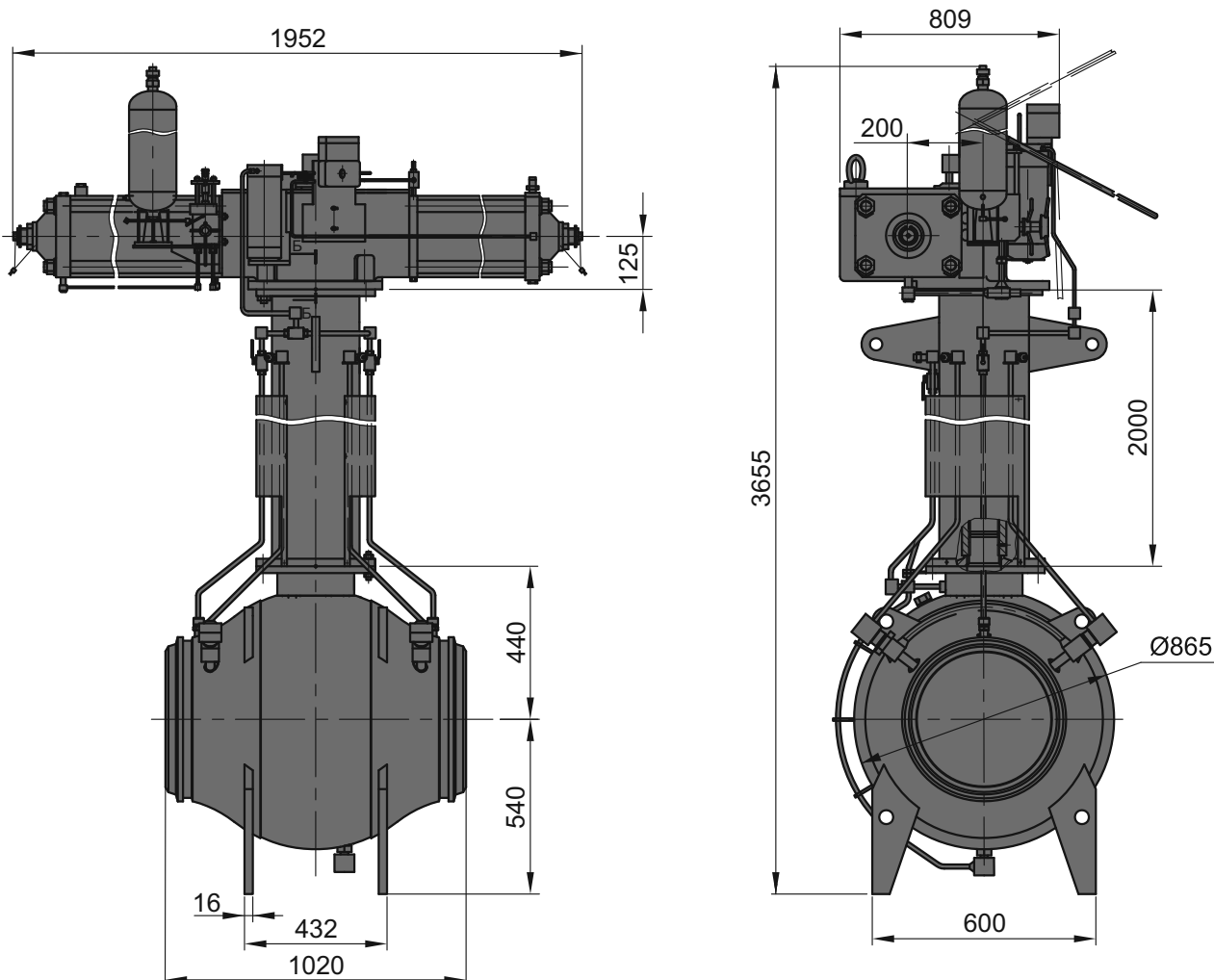

Product designation

Figure designation

Diameter Nominal, DN, mm
Pressure Nominal, PN, MPa
Actuator type

Control unit

Actuator operating medium
Pressure range of operating medium
at pressure differential on valve
closure member up to 2.0 MPa, MPa
Control unit voltage
Connection
Weight, max, kg

KSh-500-100-PGP-PU-UKhL1-Pr

1.2750.315.160.00

500
10.0
pneumatic-and-hydraulic
with manual override – hydraulic pump
electro-pneumatic with unit of limit switches
supply from pipeline

2.5...10.0
24, 110, 220 V/DC
welded end (WE)*
2680

Material of main parts

Body	steel 09Г2С, zinc chromating 24 μ
Ball	steel 20ГЛ, HCP 30 μ
Stem	steel 40X, HCP 21 μ
Seat	steel 09Г2С, zinc chromating 9 μ

* Pipe is beveled to the pipe specified by a Customer.

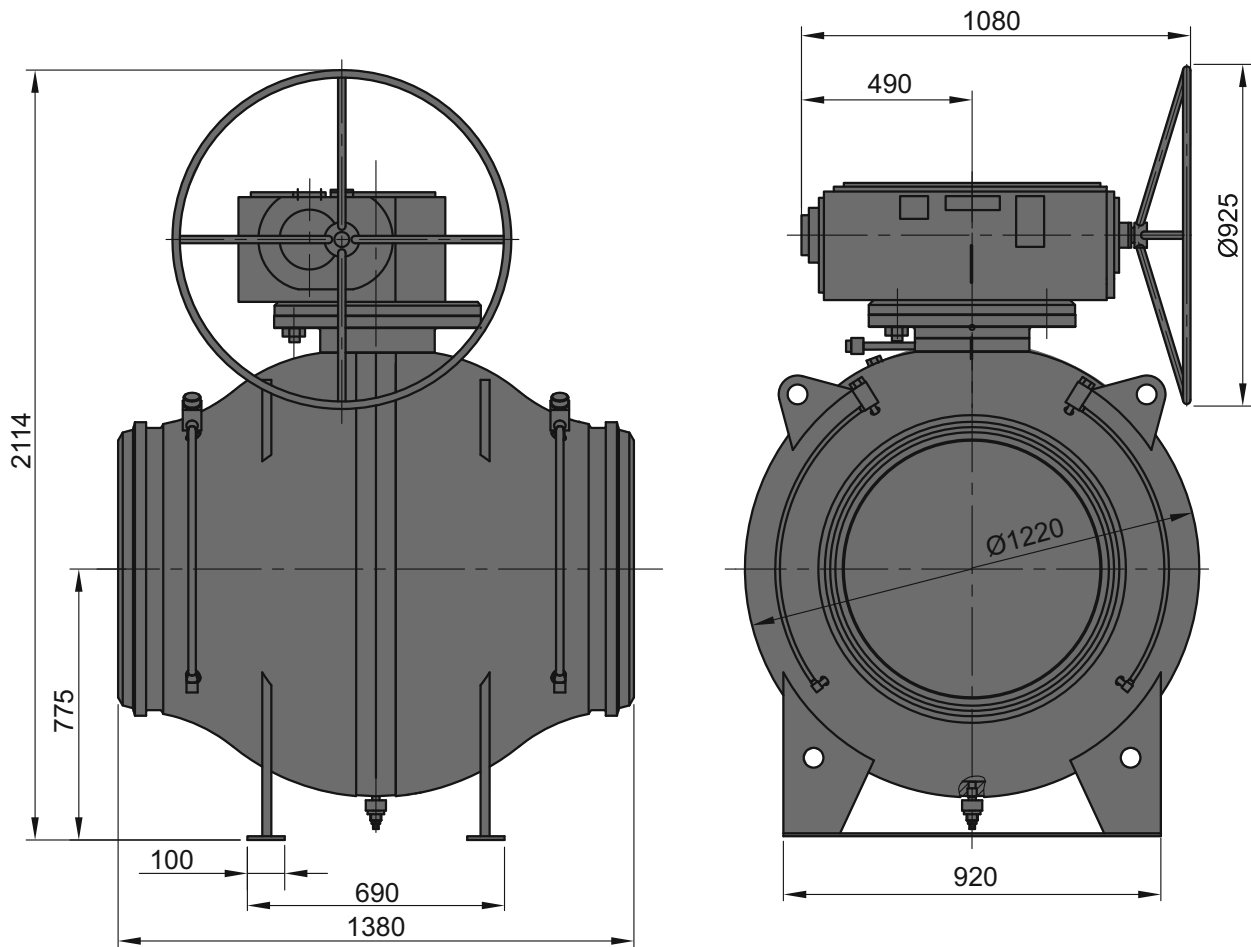

**Product designation****KSh-700-100-RP-NU-UKhL1-Pr****Figure designation****1.2750.148.101.00-08**

Diameter Nominal, DN, mm

700

Pressure Nominal, PN, MPa

10.0

Actuator type

manual mechanical

Connection

welded end (WE)*

Weight, max, kg

3955

Material of main parts

Body

steel 09Г2С

Ball

steel 20ГЛ, HCP 30 μ

Stem

steel 40X, HCP 21 μ

Seat (cover)

steel 09Г2С, zinc chromating 9 μ

* Pipe is beveled to the pipe specified by a Customer.



Ball Valve DN 700 PN 100 with Manual Actuator for Underground Installation

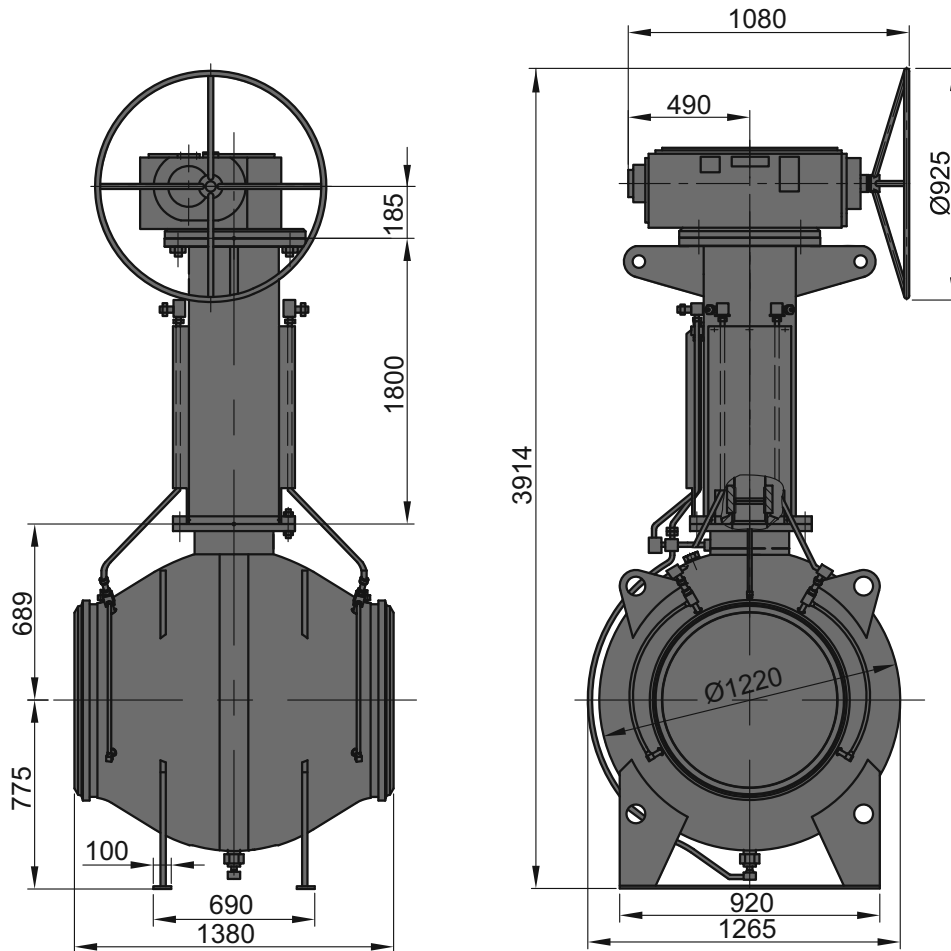

Product designation

Figure designation

Diameter Nominal, DN, mm
Pressure Nominal, PN, MPa
Actuator type
Connection
Weight, max, kg

KSh-700-100-RP-PU-UKhL1-Pr

1.2750.155.101.00-02

700
10.0
manual mechanical
welded end (WE)*
4780

Material of main parts

Body	steel 09Г2С
Ball	steel 20ГЛ, HCP 30 μ
Stem	steel 40X, HCP 21 μ
Seat (cover)	steel 09Г2С, zinc chromating 9 μ

* Pipe is beveled to the pipe specified by a Customer.



Ball Valve DN 700 PN 100 with Pneumatic-and-Hydraulic Actuator

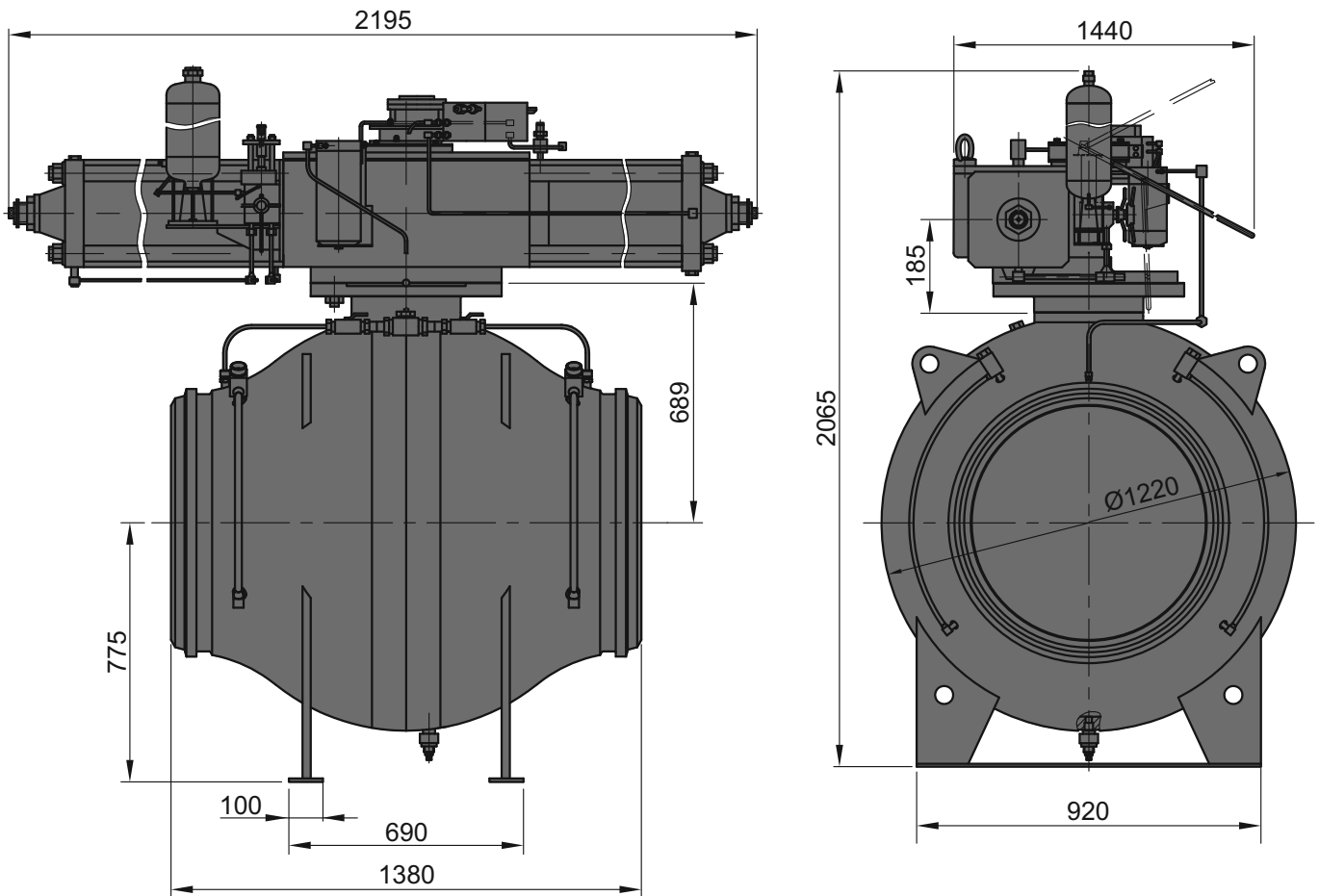

Product designation

Figure designation

Diameter Nominal, DN, mm
Pressure Nominal, PN, MPa
Actuator type

Control unit

Actuator operating medium

Min. control pressure at pressure differential
at valve closure member up to 2.0 MPa, MPa

Control unit voltage

Connection

Weight, max, kg

KSh-700-100-PGP-NU-UKhL1-Pr

1.2750.148.104.00-06

700

10.0

pneumatic-and-hydraulic

with manual override – hydraulic pump

electro-pneumatic with unit of limit switches

supply from pipeline

2.5

24, 110, 220 V/DC

welded end (WE)*

4205

Material of main parts

Body

steel 09Г2С, zinc chromating 24 μ

Ball

steel 20ГЛ, HCP 30 μ

Stem

steel 40X, HCP 21 μ

Seat

steel 09Г2С, zinc chromating 9 μ

* Pipe is beveled to the pipe specified by a Customer.



Ball Valve DN 700 PN 100 with Pneumatic-and-Hydraulic Actuator for Underground Installation

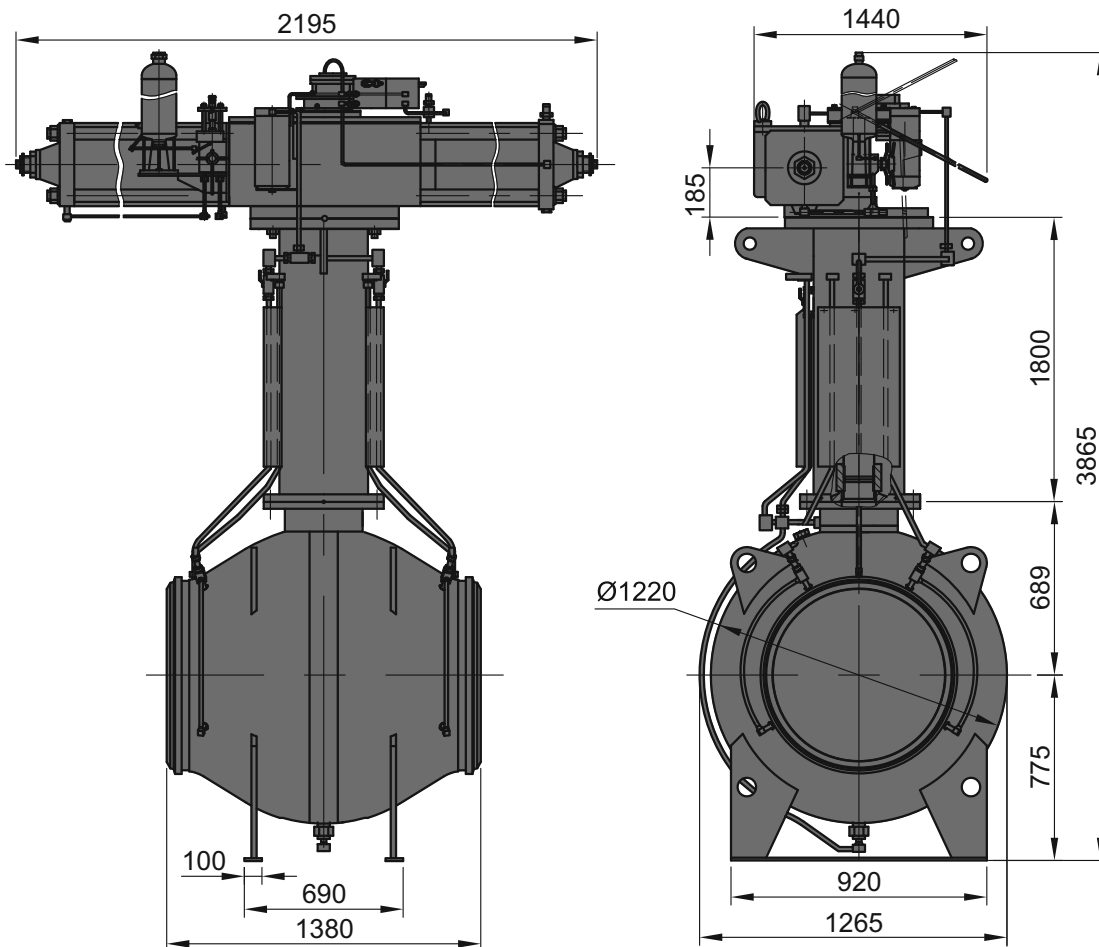

Product designation

Figure designation

Diameter Nominal, DN, mm
Pressure Nominal, PN, MPa
Actuator type

Control unit

Actuator operating medium

Min. control pressure at pressure differential at valve closure member up to 2.0 MPa, MPa

Control unit voltage

Connection

Weight, max, kg

KSh-700-100-PGP-PU-UKhL1-Pr

1.2750.156.104.00-02

700

10.0

pneumatic-and-hydraulic
with manual override – hydraulic pump
electro-pneumatic with unit of limit switches
supply from pipeline

2.5

24, 110, 220 V/DC

welded end (WE)*

5040

Material of main parts

Body

steel 09Г2С, zinc chromating 24 μ

Ball

steel 20ГЛ, HCP 30 μ

Stem

steel 40X, HCP 21 μ

Seat

steel 09Г2С, zinc chromating 9 μ

* Pipe is beveled to the pipe specified by a Customer.



Ball Valve DN 1000 PN 100 with Pneumatic-and-Hydraulic Actuator

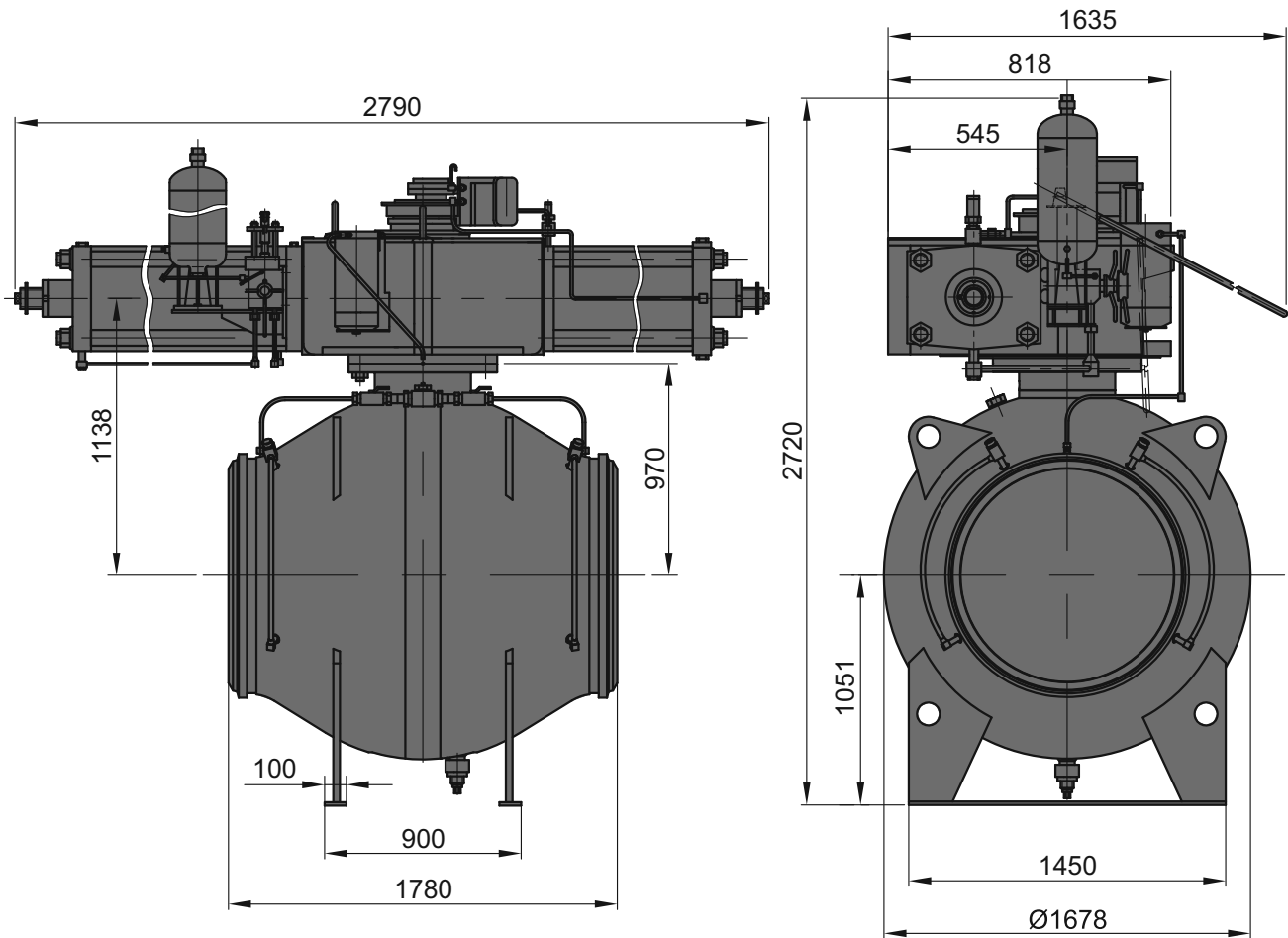

Product designation

Figure designation

Diameter Nominal, DN, mm
Pressure Nominal, PN, MPa
Actuator type

Control unit

Control unit voltage

Actuator operating medium

Min. control pressure at pressure differential
at valve closure member up to 2.0 MPa, MPa

Connection

Weight, max, kg

KSh-1000-100-PGP-NU-UKhL1-Pr

1.2750.149.104.00-02

1000

10.0

pneumatic-and-hydraulic
with manual override – hydraulic pump
electro-pneumatic with unit of limit switches
24, 110, 220 V/DC
supply from pipeline

2.5

welded end (WE)*

12000

Material of main parts

Body

steel 09Г2С, zinc chromating 24 μ

Ball

steel 20ГЛ, HCP 30 μ

Stem

steel 40X, HCP 21 μ

Seat

steel 09Г2С, zinc chromating 9 μ

* Pipe is beveled to the pipe specified by a Customer.



Ball Valve DN 1000 PN 100 with Pneumatic-and-Hydraulic Actuator for Underground Installation

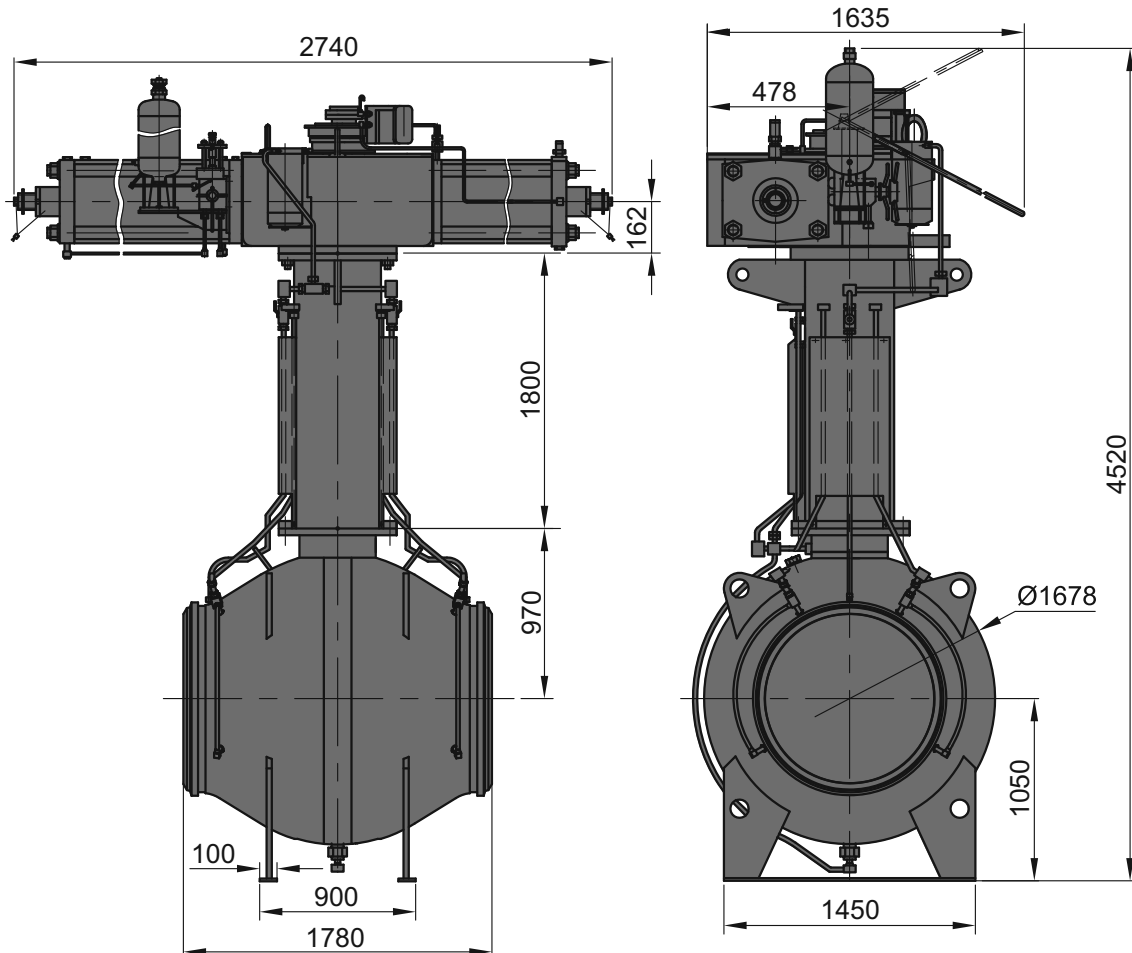

Product designation

Figure designation

Diameter Nominal, DN, mm
Pressure Nominal, PN, MPa
Actuator type

Control unit

Control unit voltage

Actuator operating medium

Min. control pressure at pressure differential at valve closure member up to 2.0 MPa, MPa

Connection

Weight, max, kg

KSh-1000-100-PGP-PU-UKhL1-Pr

1.2750.157.104.00-02

1000

10.0

pneumatic-and-hydraulic
with manual override – hydraulic pump
electro-pneumatic with unit of limit switches

24, 110, 220 V/DC

supply from pipeline

2.5

welded end (WE)*

13300

Material of main parts

Body

steel 09Г2С, zinc chromating 24 μ

Ball

steel 20ГЛ, HCP 30 μ

Stem

steel 40X, HCP 21 μ

Seat

steel 09Г2С, zinc chromating 9 μ

* Pipe is beveled to the pipe specified by a Customer.



Ball Valve DN 1200 PN 100 with Pneumatic-and-Hydraulic Actuator

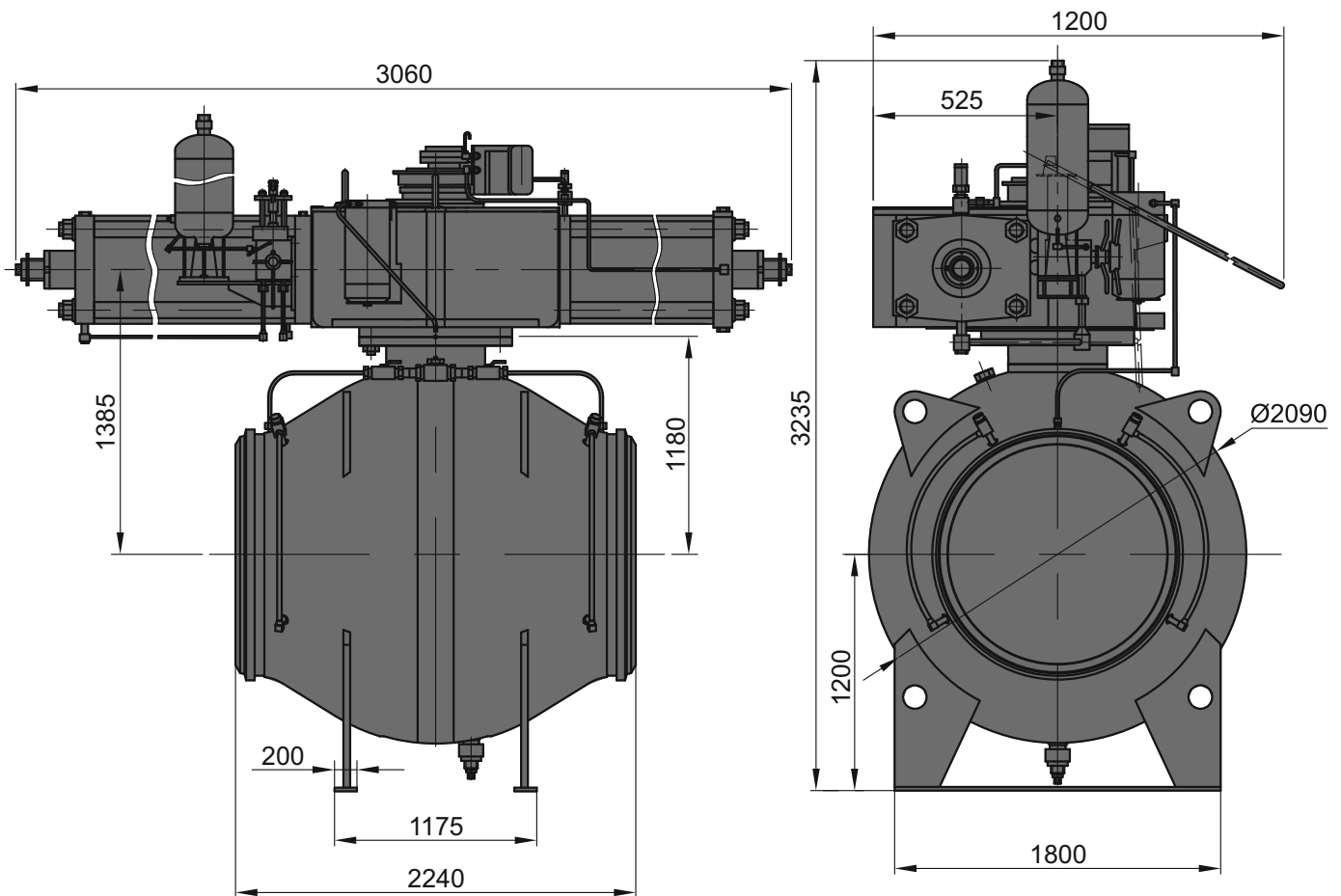

Product designation

Figure designation

Diameter Nominal, DN, mm
Pressure Nominal, PN, MPa
Actuator type

Control unit

Control unit voltage

Actuator operating medium

Min. control pressure at pressure differential
at valve closure member up to 2.0 MPa, MPa

Connection

Weight, max, kg

KSh-1200-100-PGP-NU-UKhL1-Pr

1.2750.163.104.00-02

1200

10.0

pneumatic-and-hydraulic
with manual override – hydraulic pump
electro-pneumatic with unit of limit switches
24, 110, 220 V/DC
supply from pipeline

2.5

welded end (WE)*

20425

Material of main parts

Body

steel 09Г2С

Ball

steel 20ГЛ, HCP 30 μ

Stem

steel 45ХГМА, HCP 21 μ

Seat

steel 09Г2С, zinc chromating 9 μ

* Pipe is beveled to the pipe specified by a Customer.



Ball Valve DN 1200 PN 100 with Pneumatic-and-Hydraulic Actuator for Underground Installation

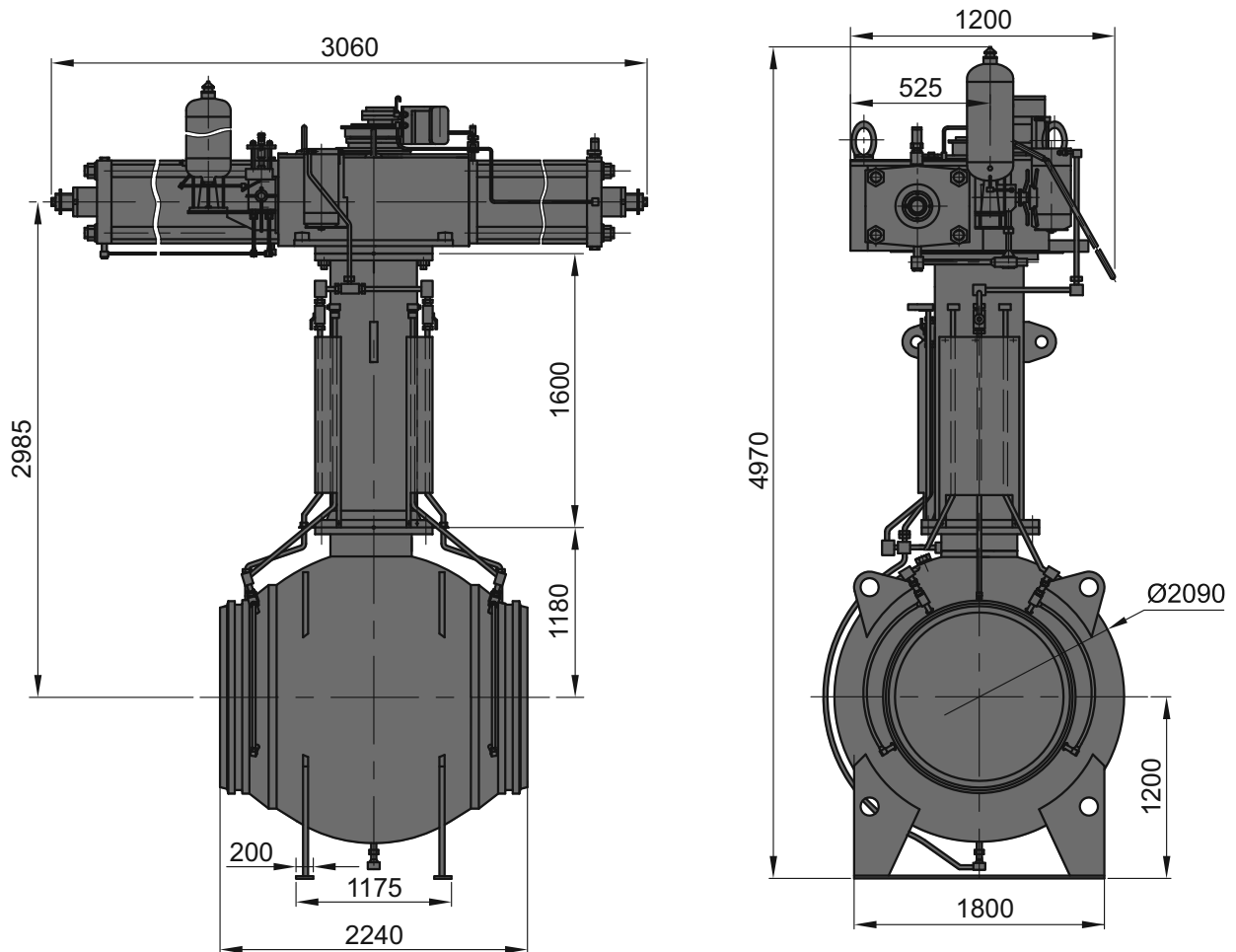

Product designation

Figure designation

Diameter Nominal, DN, mm
Pressure Nominal, PN, MPa
Actuator type

Control unit

Control unit voltage, V

Actuator operating medium

Min. control pressure at pressure differential at valve closure member up to 2.0 MPa, MPa

Connection

Weight, max, kg

KSh-1200-100-PGP-PU-UKhL1-Pr

1.2750.166.104.00

1200

10.0

pneumatic-and-hydraulic
with manual override – hydraulic pump
electro-pneumatic with unit of limit switches

DC 24, 110, 220

supply from pipeline

2.5

welded end (WE)*

21400

Material of main parts

Body

steel 09Г2С

Ball

steel 20ГЛ, HCP 30 μ

Stem

steel 45ХГМА, HCP 21 μ

Seat

steel 09Г2С, zinc chromating 9 μ

* Pipe is beveled to the pipe specified by a Customer.



Ball Valve DN 1400 PN 100 with Pneumatic-and-Hydraulic Actuator

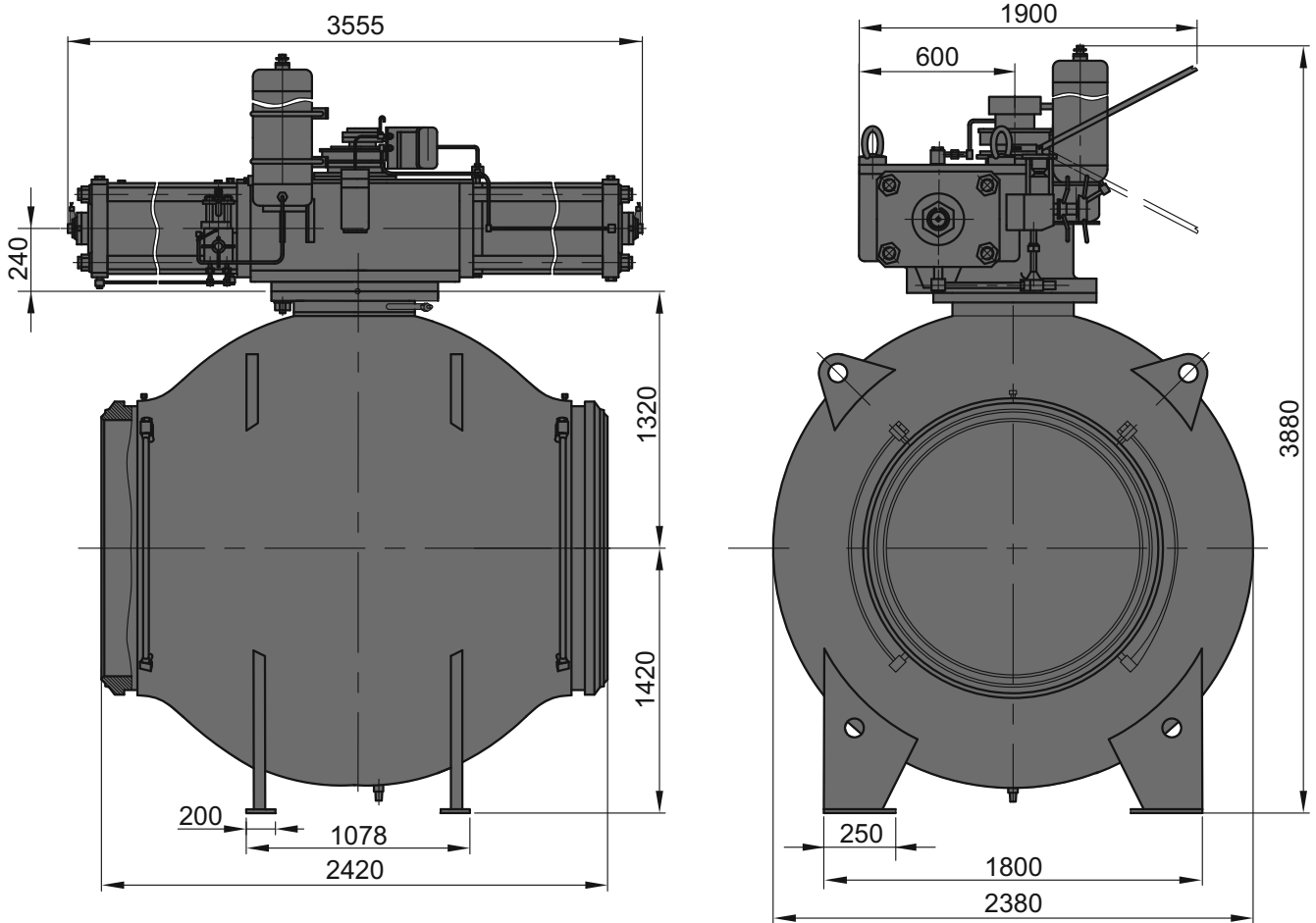

Product designation

Figure designation

Diameter Nominal, DN, mm
Pressure Nominal, PN, MPa
Actuator type

Control unit

Control unit voltage, V
Actuator operating medium

Min. control pressure at pressure differential
at valve closure member up to 2.0 MPa, MPa

Connection

Weight, max, kg

KSh-1400-100-PGP-NU-UKhL1-Pr

1.2750.277.104.00

1400
10.0
pneumatic-and-hydraulic
with manual override – hydraulic pump
electro-pneumatic with unit of limit switches
DC 24, 110, 220
non-aggressive gaseous,
supply from pipeline

2.5

welded end (WE)*

25314

Material of main parts

Body	steel 09Г2С
Ball	steel 20ГЛ, HCP 30 μ
Stem	steel 30X H3 MΦA, HCP 21 μ
Seat	steel 09Г2С, zinc chromating 9 μ

* Pipe is beveled to the pipe specified by a Customer.



Ball Valve DN 1400 PN 100 with Pneumatic-and-Hydraulic Actuator for Underground Installation

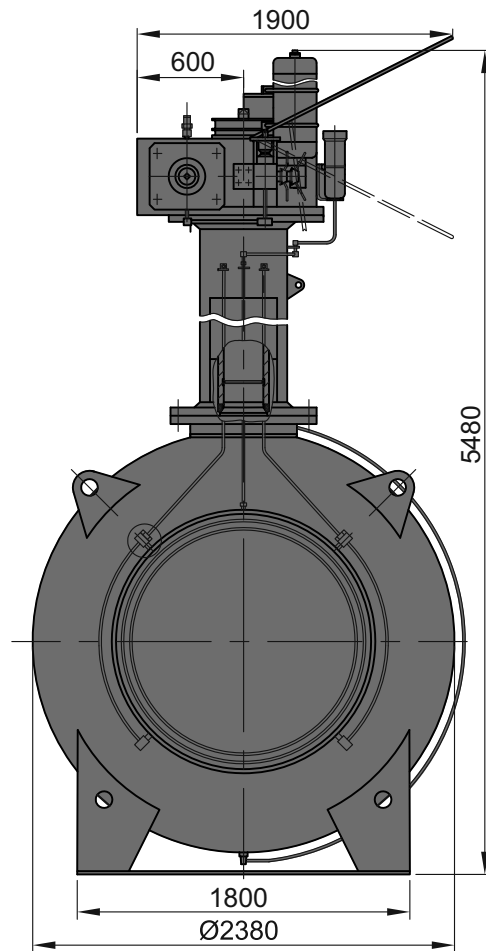
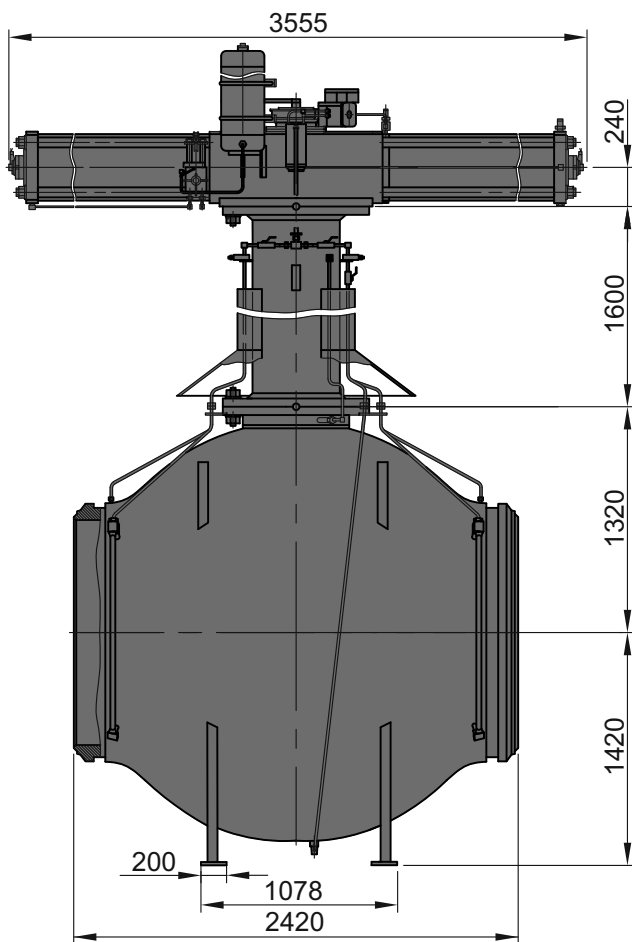

Product designation

Figure designation

Diameter Nominal, DN, mm
Pressure Nominal, PN, MPa
Actuator type

Control unit
Control unit voltage, V
Actuator operating medium

Min. control pressure at pressure differential
at valve closure member up to 2.0 MPa, MPa

Connection

Weight, max, kg

KSh-1400-100-PGP-NU-UKhL1-Pr

1.2750.277.104.00

1400
10.0
pneumatic-and-hydraulic
with manual override – hydraulic pump
electro-pneumatic with unit of limit switches
DC 24, 110, 220
non-aggressive gaseous,
supply from pipeline

2.5
welded end (WE)*
25314

Material of main parts

Body	steel 09Г2С
Ball	steel 20ГЛ, HCP 30 μ
Stem	steel 30X H3 MΦA, HCP 21 μ
Seat	steel 09Г2С, zinc chromating 9 μ

* Pipe is beveled to the pipe specified by a Customer.

